

# City of Sheffield Blackburn Valley (Butterthwaite Lane to Loicher Lane) Public Bridleway Creation Order 2012 Highways Act 1980 Section 26.

## NOTES / REVISIONS:

Copyright Sheffield City Council. All rights reserved in Chapter IV of the Copyright, Designs and Patents Act 1988 have been generally asserted

This map is reproduced from Ordnance Survey material with the permission of Ordnance Survey on behalf of the Controller of Her Majesty's Stationery Office. © Crown Copyright. Unauthorised reproduction infringes Crown copyright and may lead to prosecution or civil proceedings. 10018916, 2009

EXECUTED as a Deed by  
The Sheffield City Council whose  
Common Seal was hereunto  
affixed in the presence of:-

Duly Authorised Signatory

*[Signature]*



12/89/332

SHEFFIELD CITY COUNCIL  
DEVELOPMENT SERVICES

Director  
L STURCH, MRTPI

SCHEME:  
Blackburn Valley  
Bridleway Creation Order

TITLE:  
Butterthwaite Lane  
To Loicher Lane

COMMITTEE:

SCALE:  
Refer to scale bar

Dr	Tr	Ckd	Date	Micro
JAG			Sept 2012	

Drawing No:  
EP61/13/A

CAD FILE NAME:

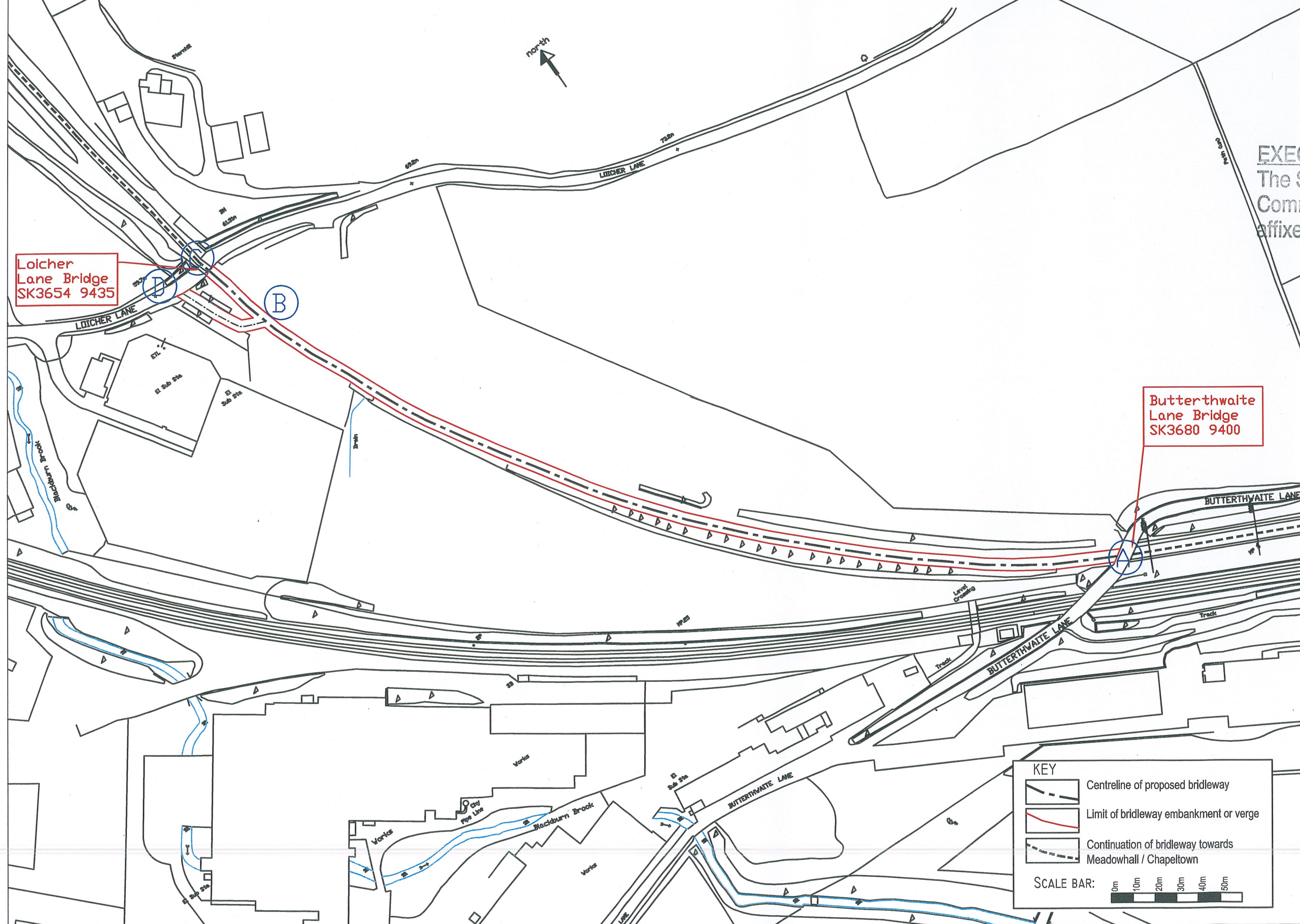

**KEY**

- Centreline of proposed bridleway
- Limit of bridleway embankment or verge
- Continuation of bridleway towards Meadowhall / Chapeltown

**SCALE BAR:** 0m 10m 20m 30m 40m 50m