

PROPOSED STOPPING UP OF HIGHWAY AT EARL MARSHAL VIEW,
PART OF EARL MARSHAL DRIVE, PART OF EARL MARSHAL CLOSE AND
THIRTEEN FOOTPATHS, FIR VALE, SHEFFIELD.

1.0 PURPOSE

- 1.1 To seek authority to support the proposed Stopping-Up Order required for Earl Marshal View, part of Earl Marshal Drive and part of Earl Marshal Close and thirteen footpaths at Fir Vale, Sheffield.

2.0 BACKGROUND

- 2.1 An application to make a Highways Stopping-Up Order, under Section 247 of the Town and Country Planning Act 1990, has been made to the Department for Transport National Transport Casework Team (N.T.C.T.)
- 2.2 N.T.C.T has contacted the City Council, as a statutory consultee, in respect of the proposed closure referred to below.
- 2.3 The applicant is seeking the closure of Earl Marshal View, part of Earl Marshal Drive, part of Earl Marshal Close and the full length of thirteen footpaths in the Fir Vale area of Sheffield. Planning permission for the site has been granted under application number 15/00659/FUL for the erection of 59 dwellinghouses with associated access roads, footpaths, car parking accommodation and landscaping works including sustainable urban drainage system (SUDS) storage pond.
- 2.4 In order to facilitate the approved development, it is necessary to permanently stop up the areas of highway shown by hatching on the closure plan included as Appendix A.

3.0 CONSULTATIONS

- 3.1 In this particular case, it is not the role of the City Council to consult the statutory organisations and other relevant bodies. However, as part of the process of making the application to N.T.C.T, the applicant should have consulted the usual sources and been in discussion with affected parties concerning the resiting and protection of their equipment. At the time of writing this report the Council had not received notification of any objections.

4.0 LEGAL IMPLICATIONS

- 4.1 The Director of Legal Services has been consulted and has advised that, assuming the areas of highway need to be stopped up to facilitate the approved development, it would be appropriate to process the closure using powers contained within the Town & Country Planning Act 1990, Section 247.

5.0 HIGHWAY IMPLICATIONS

- 5.1 Earl Marshal View, Earl Marshal Drive and Earl Marshal Close are unclassified all-purpose adopted highways.
- 5.2 The majority of the footpaths, proposed for closure, originally provided access to housing (now demolished) at this site. However, the footpaths numbered 2 and 3 on the plan attached as Appendix A provide a direct link between Earl Marshal Road and Barnsley Road. Footpath 2 has been informally stopped-up for a number of years, during which time no complaints regarding the obstruction have been received. Footpath 3 currently terminates at the cul-de-sac of Skinnerthorpe Road. An alternative link is to be provided, retaining the pedestrian access between Earl Marshal Road and Barnsley Road.
- 5.3 The loss of these sections of highway therefore should not affect the public's enjoyment of this area. The closures are necessary for the approved development and will have no detrimental effect on the surrounding highway network and its users.
- 5.4 The Council is satisfied that it is necessary to close the existing highways as shown on the plan attached as Appendix A

6.0 EQUAL OPPORTUNITY IMPLICATIONS

- 6.1 No particular equal opportunity implications arise from the proposal in this report.

7.0 ENVIRONMENTAL IMPLICATIONS

- 7.1 No particular environmental implications arise from the proposal in this report.

8.0 FINANCIAL IMPLICATIONS

- 8.1 The cost of the accrual of the new lengths of highway into the Streets Ahead Contract will be offset by the saving from the de-accrual of the length of highway that is to be closed. Overall there will be a saving on the Highway Maintenance Revenue Budget.
- 8.2 All costs associated with, and arising from, the application for the permanent highway closure, and consequent works on site, will be met by the applicant.

9.0 CONCLUSION

- 9.1 Based on the above information, I have no objections to the proposed closure of Earl Marshal View, part of Earl Marshal Drive, part of Earl Marshal Close and thirteen footpaths as shown by hatching on the plan included as Appendix A.

10.0 RECOMMENDATIONS

- 10.1 No objections are raised to the proposed stopping-up of Earl Marshal View, part of Earl Marshal Drive, part of Earl Marshal Close and thirteen footpaths shown by hatching on the plan included as Appendix A, subject to satisfactory arrangements being made with the Statutory Undertakers with regards to such of their mains and services that may be affected.

- 10.2 Authorises the Director of Legal Services to notify N.T.C.T. of this decision.

Mark Reeder

Senior Technician
Highway Records.

6th August 2014

REPORT APPROVED BY HEAD OF TRANSPORT, TRAFFIC AND
PARKING SERVICES

Signed 
Date 6-8-15

HIGHWAYS AT SHEFFIELD IN THE CITY OF SHEFFIELD

APPENDIX A

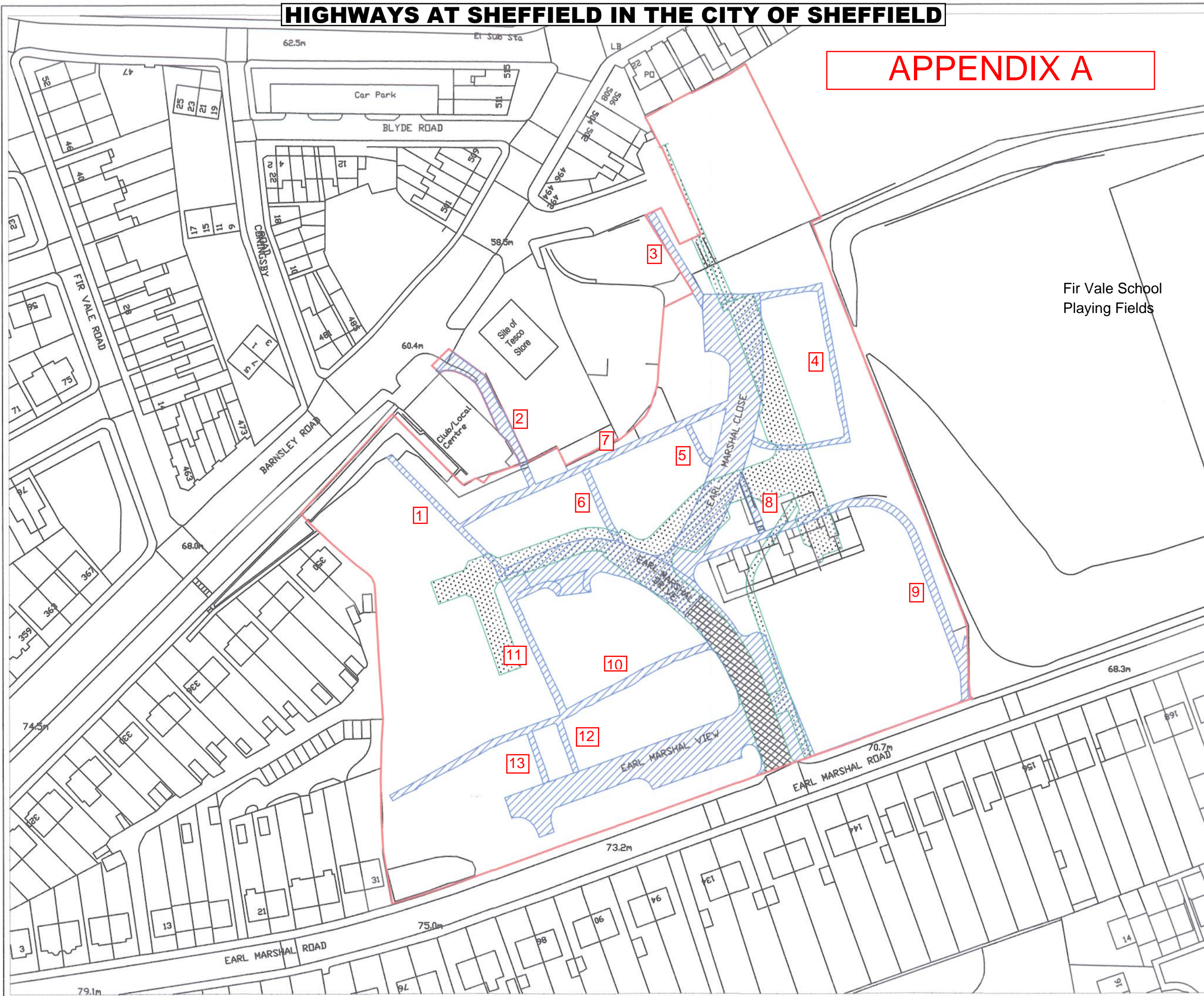
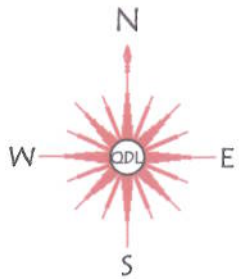

Key Scale 1:1000 at A3

Highway to be stopped up 

Highway to be improved 

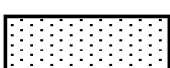
New highway to be provided 

National Transport Casework Team

Department for Transport

Plan No: NATTRAN/Y&H/S247/1923

Signed by Authority of the Secretary of State

on.....2015

Signature.....

VICTORIA POINTER
An Official in the
National Transport Casework Team
Department for Transport