

# HIGHWAYS AT SHEFFIELD IN THE CITY OF SHEFFIELD

## APPENDIX A

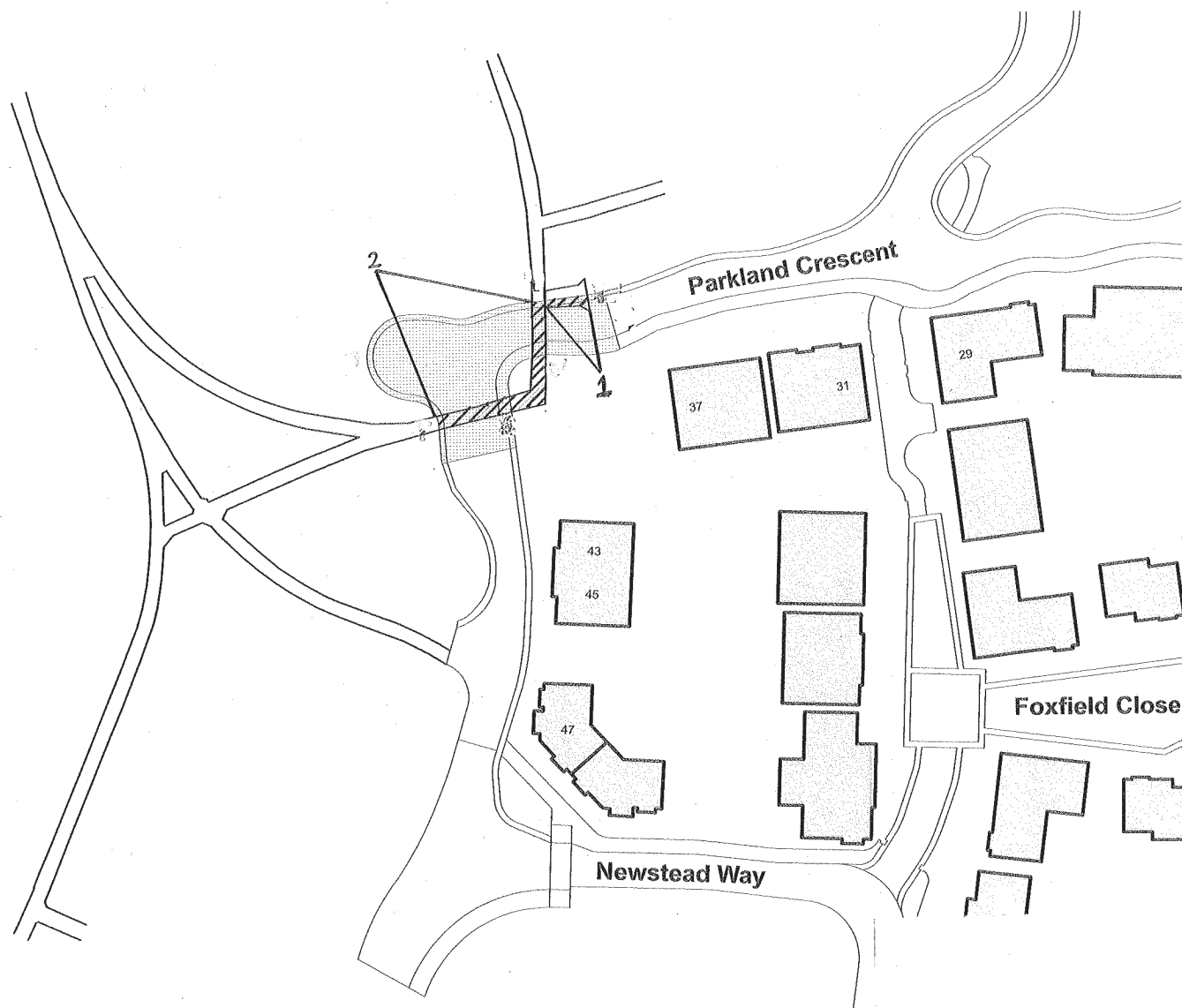

Key Scale 1:500

Highways to be stopped up

New highways to be provided

National Transport Casework Team

Department for Transport

Plan No:  
NATTRAN/Y&H/S247/664

OS Grid Ref

E: 440550, N: 382871

Post Code: S12 3BU

Signed by Authority of the  
Secretary of State

on.....2012

Signature.....

SANDRA ZAMENZADEH  
An Official in the  
National Transport Casework Team  
Department for Transport

# HIGHWAYS AT SHEFFIELD IN THE CITY OF SHEFFIELD

## APPENDIX B

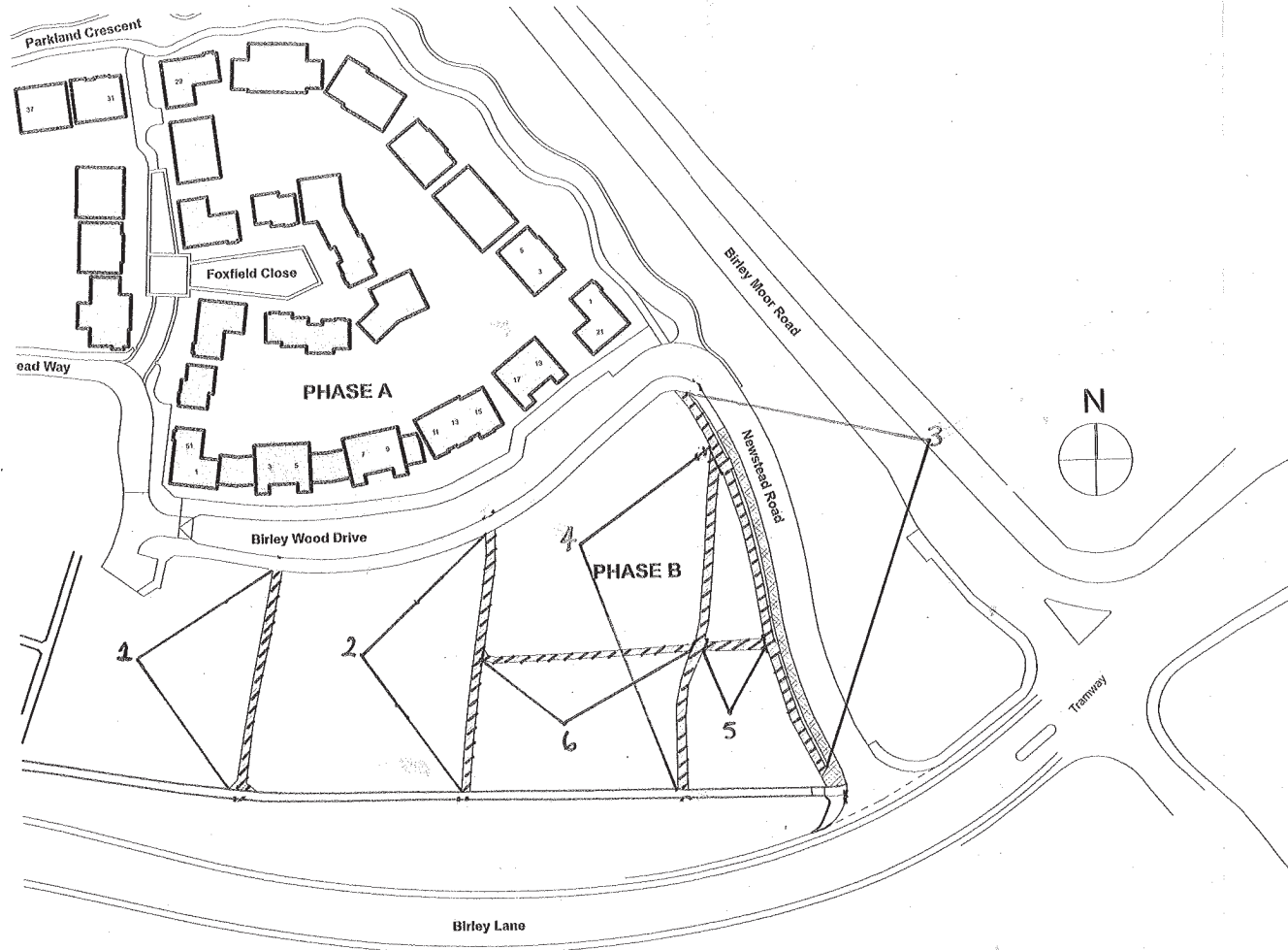

Key Scale 1:1000

Highways to be stopped up

Highway to be improved

National Transport Casework Team

Department for Transport

Plan No: NATTRAN/Y&H/S247/665

OS Grid Ref

E: 440550, N: 382871

Post Code: S12 3BU

Signed by Authority of the Secretary of State

on.....2012

Signature.....

SANDRA ZAMENZADEH  
An Official in the  
National Transport Casework Team  
Department for Transport





Highway Records  
Development Services  
Howden House  
Union Street  
Sheffield  
S1 2SH

## APPENDIX C

Town and Country Planning Act 1990 Section 247  
Proposed Highway Closures at Newstead Estate,  
Phases A & B, in the Birley area of Sheffield.

REF.: BM/HR/3941/3942

WIDER LOCATION PLAN Scale: 1:25,000

