



**POLLUTION PREVENTION AND CONTROL ACT 1999
ENVIRONMENTAL PERMITTING (ENGLAND & WALES) REGULATIONS 2010
(as amended)**

**Permit Number: 6.4/050632/cp
Scania (GB) Limited
Don Road
Sheffield
S9 2TL**

In accordance with Regulation 13 of the Environmental Permitting (England & Wales) Regulations 2010 as amended, Scania (GB) Limited, Ripley Drive, Normanton Industrial Estate, Normanton, WF6 1QT, is hereby permitted to operate a scheduled activity at the address detailed above, namely the operation of repainting or respraying of road vehicles as described in Schedule 1, Part 2, Chapter 1, Section 6.4, Part B, and subject to the following conditions of this Permit.

Signed

Dated this day 27th March 2013

**Assistant Manager
Authorised by Sheffield City Council to sign on their behalf**

The Secretary of States Guidance PG 6/34 (11) "Re-spraying of Road Vehicles" has provided the framework for the conditions in this permit

Name & Address of Operator:

Scania (GB) Limited
Don Road
Sheffield
S9 2RL

Registered Office:

Scania (GB) Limited
Delaware Drive
Tongwell
Milton Keynes
MK15 8HB

Address of Permitted Installation:

Scania (GB) Limited
Don Road
Sheffield
S9 2RL

Site Manager Name and telephone number:

Richard Gilliland
General Manager

Tel No – 0114 2626700

Any communication with Sheffield City Council should be made to the following address quoting the Permit Number:

**ENVIRONMENTAL PROTECTION SERVICE
SHEFFIELD CITY COUNCIL
2-10 CARBROOK HALL ROAD
CARBROOK
SHEFFIELD
S9 2DB**

Alternatively Email: epsadmin@sheffield.gov.uk or ring Tel 273 4651.

Explanatory Note to Pollution Prevention and Control Permit for Part B Installations.

(This note does not form a part of the Permit)

The following Permit is issued under Regulation 13 of the Environmental Permitting (England and Wales) Regulations 2010, to operate an installation carrying out activities covered by the description in Part 2, Chapter 1, Section 6.4, Part B, of those Regulations, to the extent authorised by the Permit:

Process Changes

As part of your permit you are required to notify the Council of any proposed change in operation at least 14 days before making the change. This must be in writing and must contain a full description of the proposed change in operation and the likely consequences. Failure to do so is an offence.

If you consider that a proposed change could result in the breach of the existing permit conditions or is likely to require the variation of permit conditions then you may apply in writing under Regulation 20(1) of the EP Regulations. Additionally, if this involves a SUBSTANTIAL CHANGE to the installation you will be required to submit an application, pay the relevant fee and advertise the application accordingly. You may serve a Notice on the Council requesting that they determine whether any change that is proposed would constitute a substantial change before you proceed with application.

Variations to the Permit

The Permit may be varied in the future (by the Council serving a Variation Notice on the Operator). If the Operator itself wants any of the Conditions of the Permit to be changed, a formal Application must be submitted.

Surrender of the Permit

Where the operator of a Part B installation or mobile plant ceases or intends to cease the operation of the activity the operator may notify the regulator of the surrender of the whole permit, in any other case, notify the regulator of the surrender of the permit in so far as it authorises the operation of the installation or mobile plant which he/she has ceased or intends to cease operating. The notification shall contain information as described in Regulation 24 or 25 of the EP Regulations.

Transfer of the Permit or Part of the Permit

Before the Permit can be wholly or partially transferred to another person, a joint application to transfer the Permit has to be made by both the existing and proposed holders, in accordance with Regulation 21 of the EP Regulations. A transfer will be allowed unless Sheffield City Council considers that the proposed holder will not be the person who will have control over the operation of the installation or will not ensure compliance with the conditions of the transferred Permit.

Annual Subsistence Fee

In accordance with Regulation 65 of the EP Regulations, the holder of a permit is required to pay a fee for the subsistence of the Permit. This fee is payable annually on 1st April. You are advised that under the provisions of Regulation 65 (5) of the EP Regulations, if you fail to pay the fee due promptly, Sheffield City Council may revoke the Permit. You will be contacted separately each year in respect to this payment.

Public Register

The Council is required by Regulation 46 of the EP Regulations to maintain a Public Register containing information on all LAPPC installations and mobile plant. The register is available for inspection by the public free of charge during office hours (Monday to Friday 9.00 am to 5.00 pm) at the following address:

Environmental Protection Service
Sheffield City Council
2-10 Carbrook Hall Road
Carbrook
Sheffield
S9 2DB

Tel: 0114 273 4651

Confidentiality

Sheffield City Council has a duty to consider the question of confidentiality of information supplied to it. If any information supplied is considered confidential, a statement of which information this applies to and the reasons why it is considered confidential should be specified. The Operator is reminded that he may apply to Sheffield City Council for the exclusion of information from the public register under the provisions of the Environmental Permitting (England and Wales) Regulations 2010 as amended.

Appeals

Under Regulation 31 of the EP Regulations operators have the right of appeal against the conditions attached to their permit. Schedule 6 of the EP Regulations sets out the detailed procedures.

Appeals against a Variation Notice do not have the effect of suspending the operation of the Notice. Appeals do not have the effect of suspending Permit conditions.

Notice of appeal against the conditions attached to the permit must be given within six months of the date of the Notice, which is the subject matter of the appeal.

How to Appeal

There are no forms or charges for appealing. However, for an appeal to be valid, appellants (the person/operator making the appeal) are legally required to provide:

- Written notice of the appeal;
- A statement of the grounds of appeal;
- A statement indicating whether the appellant wishes the appeal to be dealt with by written representations procedure or a hearing - a hearing must be held if either the appellant or enforcing authority requests this, or if the Planning Inspector or the Secretary of State decides to hold one.
- (Appellants must copy the above three items to the local authority when the appeal is made)
- A copy of any relevant application;
- A copy of any relevant permit;
- A copy of any relevant correspondence between the appellant and the regulator; and
- A copy of any decision or notice, which is the subject matter of the appeal.

Where to Send Your Appeal Documents

Appeals should be addressed to:

**The Planning Inspectorate
Environmental Appeals Administration
Room 4/19 - Eagle Wing
Temple Quay House
2 The Square
Temple Quay
Bristol BS1 6PN**

In the course of an Appeal process the main parties will be informed of procedural steps by the Planning Inspectorate.

To withdraw an appeal the appellant must notify the Planning Inspectorate in writing and copy the notification to the local authority.

Contents

	PAGE
Explanatory Note	3
Description of Process	7
Conditions of Permit	8
Section 1 Upgrades	8
Section 2 Non-Volatile Organic Compound (VOC) emissions	8
Section 3 Volatile Organic Compound (VOC) emissions	10
Section 4 SMART Portable Spray Booths	12
Section 5 Visible and odorous emissions	13
Section 6 General Conditions	13
Section 7 Best Available Technique	15
Schedule 1 Installation Location	16
Schedule 2 Installation Layout	17
Schedule 3 Production Categories and Maximum, Application Ready VOC Contents	18
Schedule 4 Individual body shop products covered by this permit	19

DESCRIPTION OF PROCESS.

The spraying and respraying of road vehicles using compliant coatings containing one tonne or more of organic solvents in any twelve month period. The respraying is carried out in two commercial vehicle Spraybake ovens manufactured by Spraybake, Bradbury Drive, Springwood Industrial Estate, Rayne Road, Braintree, Essex CM7 2ET.

The process includes all ancillary operations such as the storage of raw materials, preparation of vehicles for spraying using orbital sanders extracted to dust collectors which are vented internally, the mixing of coatings, the cleaning of spray guns and the handling, storage and dispatch of wastes.

The above named company is permitted to operate a vehicle refinishing installation subject to compliance with the following conditions:

Section 1 – Upgrading

1.1 There are no upgrading requirements

Section 2- Non-VOC (Non-Volatile Organic Compound) Emissions

2.1 The following non-VOC emission limits shall apply:

Row		Source	Emission limits / provisions	Type of Monitoring	Monitoring frequency
1	Particulate matter	From spray booths	10 mg /Nm ³	By guarantee supplied by the spray booth constructor (see B1.3 of the application)	None required
		[Abrasive blasting equipment and other sources (except spray booths)]	[50 mg/Nm ³ for contained sources]	Manual extractive Testing in accordance with BS6069: Section 4.3 1992	[in accordance with the written plan (see B1.7 of the application)]
2	Sulphur dioxide	All processes / activities	1% wt/wt sulphur in fuel	Certification by supplier on first delivery.	None required
		All processes/ activities using gas oil as defined in the Sulphur Content of Certain Liquid Fuels Directive (1999/32/EC).	0.1% wt/wt sulphur in fuel		

2.2 All emissions shall be determined at the standard reference conditions of 273.15K and 101.3kPa, without correction for water vapour content.

2.3 The introduction of dilution air to achieve emission concentration limits shall not be permitted. Dilution air may be added for waste gas cooling or improved dispersion where justified, but this must not be considered when determining the mass concentration of the pollutant in the waste gases.

2.4 The operator shall implement a maintenance schedule a copy of which shall be made available to the Sheffield City Council's Environmental Protection Service upon request.

2.5 Dusty wastes shall be stored in closed containers.

2.6 Dry sweeping of dusts and dusty wastes shall not be used.

2.7 The operator shall keep records of inspections, tests and monitoring in relation to

-
- the provisions of the table above. In such cases:
- current records shall be kept on site and made available for Sheffield City Council's Environmental Protection Service to examine
 - records shall be kept by the operator for at least two years
- 2.8 The operator shall notify Sheffield City Council's Environmental Protection Service at least 7 days before any periodic monitoring exercise to determine compliance with the abrasive blasting particulate emission limit values. The operator shall state the provisional time and date of monitoring, pollutants to be tested and the methods to be used.
- 2.9 Within 8 weeks of the completion of monitoring activities, the results of non-continuous emission testing shall be forwarded to the regulator.
- 2.10 In the event of any adverse results from any monitoring activity in relation to the provisions of the above table, the operator shall investigate as soon as the results are obtained/received. The operator shall:
- identify the cause and take corrective action
 - record as much detail as possible regarding the cause and extent of the problem
 - record the action taken by the operator to rectify the situation
 - re-test to demonstrate compliance as soon as possible and
 - notify the regulator.
- 2.11 In the case of abnormal emissions, or malfunction or breakdown leading to abnormal emissions, the operator shall:
- investigate immediately and undertake corrective action
 - adjust the process or activity to minimise those emissions and
 - promptly record the events and actions taken
 - notify the regulator without delay, if the emission is likely to have an effect on the local community
- 2.12 The activities at the installation shall be carried out within the boundary outlined in green as indicated on the installation location and boundary plan shown in Schedule 1 of this Permit.
- 2.13 Permitted activities shall only be carried on using the plant and equipment as detailed in the Description of Activities.
- 2.14 The Permit holder shall ensure that Sheffield City Council's Environmental Protection Service is notified of any proposed operational changes including any alterations to the process involving the provision of new plant or equipment which may affect emissions. The information shall be submitted at least 14 days before the changes take place.
- 2.14 No plant or equipment used for any activity shall be operated with an extraction point direct to atmosphere unless specifically noted within this Permit or specifically agreed in writing with Sheffield City Council's Environmental Protection Service.
-

3.0 VOC (Volatile Organic Compound) Emissions

3.1 Surface preparation and painting operations shall be carried out using only coating materials, which are placed on the market for use in vehicle refinishing body shops as identified by a label on the container containing the following information.

- a description of the product by identification of the contents as a subcategory of Directive 2004/42/CE
- the relevant VOC limit values in g/l as referred to in Annex II of Directive 2004/42/CE and the maximum content of VOC in g/l of the product in a ready to use condition

The individual body shop products that are covered by this permit are listed in Schedule 4 of this permit.

3.2 The products used in coating shall be prepared and applied in accordance with the suppliers' instructions. Under no circumstances shall the product be thinned with more than the supplier's stated quantity or percentage of thinner. For information, the maximum, application-ready VOC contents for individual categories of products are listed in Schedule 3 of this permit.

3.3 All paint spraying operations shall be carried out in a totally enclosed booth under negative pressure, to prevent fugitive emissions of VOCs.

3.4 Spray applied coatings shall be applied to passenger cars using one of the following methods:

- high volume low pressure (HVLP) (maximum atomisation pressure 67.5kPa) spraying equipment;
- air assisted airless spraying equipment;
- electrostatic spraying equipment; or
- a system capable of achieving a transfer efficiency of at least 65%, determined in accordance with the procedure set out in BS EN 13966-1:2003 Determination of the transfer efficiency of atomising and spraying equipment for liquid coating materials.

3.5 Spray applied coatings shall be applied to commercial vehicles using one of the following techniques:

- Compliant compressed-air spraying
- High-volume low-pressure (HVLP) spraying
- Airless spraying
- Air-assisted airless spraying
- Spray processes with electrostatic assistance
- Brush/roller application
- Knifing.

-
- 3.6 All spray guns and equipment cleaning shall be carried out in an automatic, totally-enclosed equipment cleaning machine or any other equipment cleaning machine which can achieve comparable or lower emissions. The cleaning machine shall be provided with the minimum of exhaust ventilation that is necessary to prevent the fugitive emission of organic solvent vapour when the machine is opened for introduction or removal of equipment, or for the changing of cleaning solvent.
- 3.7 All spray gun testing and spray out following cleaning shall be carried out in either an equipment cleaning machine with the extraction running or into a chamber which is provided with extraction which is running in accordance with a written procedure a copy of which shall be made available to Sheffield City Council's Environmental Protection Service upon request.
- 3.8 SMART (small and medium area repair technique) is permitted to occur outside a spray booth within a protective enclosure, with or without filtration. The parts coated, as part of a repair, shall not extend to a complete panel or panels. Spraying is to be carried out only using a mini spray gun, an air brush or a pre-packaged aerosol can.
- 3.9 Cleaning solvents shall be dispensed by a piston type dispenser or similar contained device, when used on wipes.
- 3.10 Pre-impregnated solvent wipes shall be held within an enclosed container prior to use.
- 3.11 Solvent contaminated wipes and other wastes shall be handled in accordance with a written procedure a copy of which shall be made available to Sheffield City Council's Environmental Protection Service upon request.
- 3.12 Organic solvent containment and spillage equipment shall be readily available in all organic solvent handling areas.
- 3.13 All solvent containing coatings, thinners and related materials and equipment cleaning materials shall be stored
- in the containers in which they were supplied, with the lid securely fastened at all times other than when in use.
 - within spillage collectors, of suitable impervious and corrosion-proof materials and capable of containing 110% of the largest container.
 - away from sources of heat.

For information, these conditions should not conflict with the requirements of occupational health and safety regulations.

- 3.14 All solvent containing wastes shall be stored
-

-
- in suitable sealed containers with a securely fastened lid, and labelled so that all that handle them are aware of their contents.
 - within spillage collectors, of suitable impervious and corrosion-proof materials and capable of containing 110% of the largest container.
 - away from sources of heat
- 3.15 Cleaning operations involving organic solvents shall be reviewed every two years, to identify opportunities for reducing VOC emissions. This will include identification of cleaning steps that can be eliminated or alternative cleaning methods. Sheffield City Council's Environmental Protection Service shall be provided with a report on the conclusions of the review, within eight weeks of it being completed.
- 3.16 Waste solvents and waste coatings shall be recycled on/off site. Copies of receipts of waste materials sold for recycling shall be kept for three years.
- 3.17 Spares and consumables, particularly those subject to continual wear shall be held on site, or shall be available at short notice from guaranteed suppliers, so that spray booth and abrasive blasting breakdowns can be rectified rapidly.

4.0 SMART Portable spray booth.

- 4.1 Where a mobile SMART repair plant is operating a portable spray booth, the SMART repair plant filtration units shall be designed to meet the emission limit for total particulate matter of 10mg/m³. A certificate shall be submitted to Sheffield City Council's Environmental Protection Service to demonstrate compliance with this emission limit, prior to the use of the SMART repair plant.
- 4.2 SMART repair plant filtration units shall operate within a manufacturer's designated range. The range shall be visible to the operator through the use of a dial or similar device. The operator shall operate the unit within the manufacturers' range for the duration of use.
- 4.3 SMART repair plant filtration units shall be serviced and maintained in accordance with the manufacturer's recommendations, so as to maintain the validity of the guarantee of the emission concentration limit.
- 4.4 When spraying is undertaken in a portable spray booth the booth shall be closed and the filtration unit shall be operating within the manufacturer's guidelines.
- 4.5 Only Paints Directive appropriate products shall be used in the SMART repair unit.

5.0 Visible and odorous emissions

- 5.1 All releases to air, other than condensed water vapour, shall be free from persistent visible emissions.
- 5.2 All emissions to air shall be free from droplets.
- 5.3 There shall be no offensive odour beyond the site boundary, as perceived by Sheffield City Council's Environmental Protection Service.
- 5.4 Emissions from combustion processes shall in normal operation be free from visible smoke and in any case shall not exceed the equivalent of Ringelmann Shade 1, as described in British Standard BS 2742:2009.

6.0 General Conditions

- 6.1 Extraction chimneys serving the vehicle spray booths shall terminate at least eight metres above the ground and at least one metre above the roof height of any building within 15m of the base of the chimney.
- 6.2 Extraction chimneys serving each of the spray booths shall not be fitted with any restriction at the final outlet, for example a plate, cap or cowl. An accelerator cone to increase the efflux velocity to ensure compliance with condition below, is permitted.
- 6.3 The efflux velocity from the extraction chimneys serving the spraybooths shall be a minimum of 15m/s.
- 6.4 Chimney flues and ductwork leading to chimneys shall be adequately insulated to minimise the cooling of waste gases and prevent liquid condensation on internal surfaces.
- 6.5 Staff at all levels shall receive training and instructions necessary for their duties and shall include the following:
 - Responsibilities under the Permit;
 - Minimisation of emissions at start up and shut down;
 - Actions during abnormal emissions including minimisation of emissions.
- 6.6 The Permit holder shall keep and maintain a statement of training requirements for each operational post and keep a record of the training received by each employee whose actions may have an impact on emissions to atmosphere. These documents shall be made available to Sheffield City Council's Environmental Protection Service upon request.
- 6.7 A written record of all maintenance carried out in accordance with Condition

1.4 shall be made available for inspection by Sheffield City Council's Environmental Protection Service.

- 6.8 The activities shall be carried out within the areas indicated by shading on the plan in Schedule 1 to this Permit.
- 6.9 The layout of process and abatement plant shall be as indicated in Schedule 2 to this Permit.
- 6.10 The Permit holder or operator shall notify the following to Sheffield City Council's Environmental Protection Service, in writing, within 14 days of their occurrence:-
- Any change in the trading name, registered name or registered office address;
 - A change to any particulars of any ultimate holding company (including details of an ultimate holding company where the company has become a subsidiary);
 - Any steps taken with a view of going into administration, entering into a company voluntary arrangement or being wound up.
- 6.11 The Permit holder or operator shall give written notification to Sheffield City Council in the following instances;
- a) Permanent cessation of the operation of any part of, or all of the Permitted Installation;
 - b) Cessation of the operation of any part of, or all of the Permitted Installation for a period, likely to exceed 1 year;
 - c) Resumption of the operation of any part of, or all of the Permitted installation after a cessation notified under (b) Above.
- 6.12 All reports and notifications required by this Permit, or under any Regulation under the Environmental Permitting Regulations 2010, as amended, shall be sent to Sheffield City Council's Environmental Protection Service. Unless notified in writing, all reports, notifications and communications in respect of this Permit shall be sent to:

**Sheffield City Council,
Environmental Protection Service,
2-10 Carbrook Hall Road,
Sheffield
S9 2DB.**

Section 7- Best Available Techniques

- 7.1 The best available techniques shall be used to prevent or, where that is not practicable, reduce emissions from the installation in relation to any aspect of the operation of the installation which is not regulated by any other condition of this permit.

Schedule 1 – Installation Location

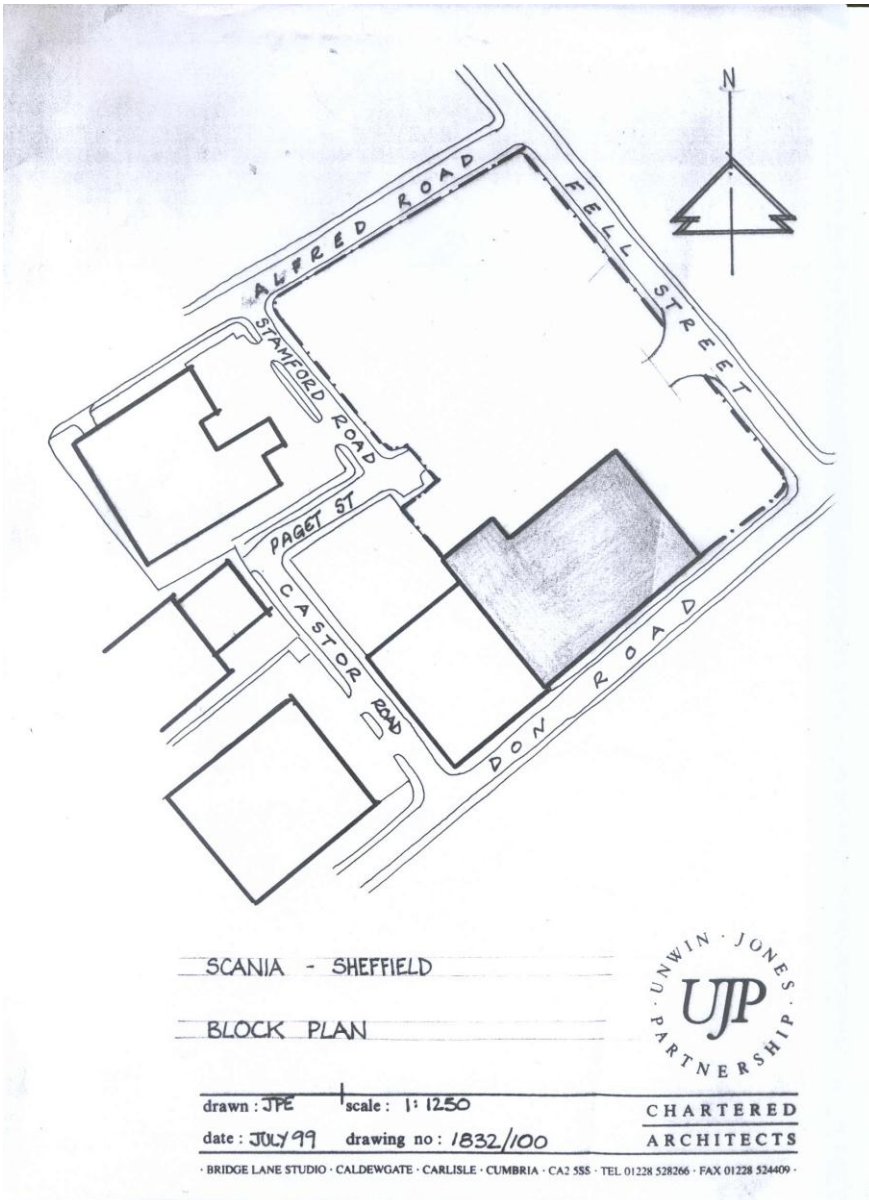

SCANIA - SHEFFIELD

BLOCK PLAN



drawn: JPE | scale: 1:1250

date: JULY 99 | drawing no: 1832/100

CHARTERED ARCHITECTS

BRIDGE LANE STUDIO · CALDEWEGATE · CARLISLE · CUMBRIA · CA2 5SS · TEL 01228 528266 · FAX 01228 524409

Schedule 2 – Installation Layout

SITE PLAN FOR BODYSHOP (SCANIA GB LTD.)

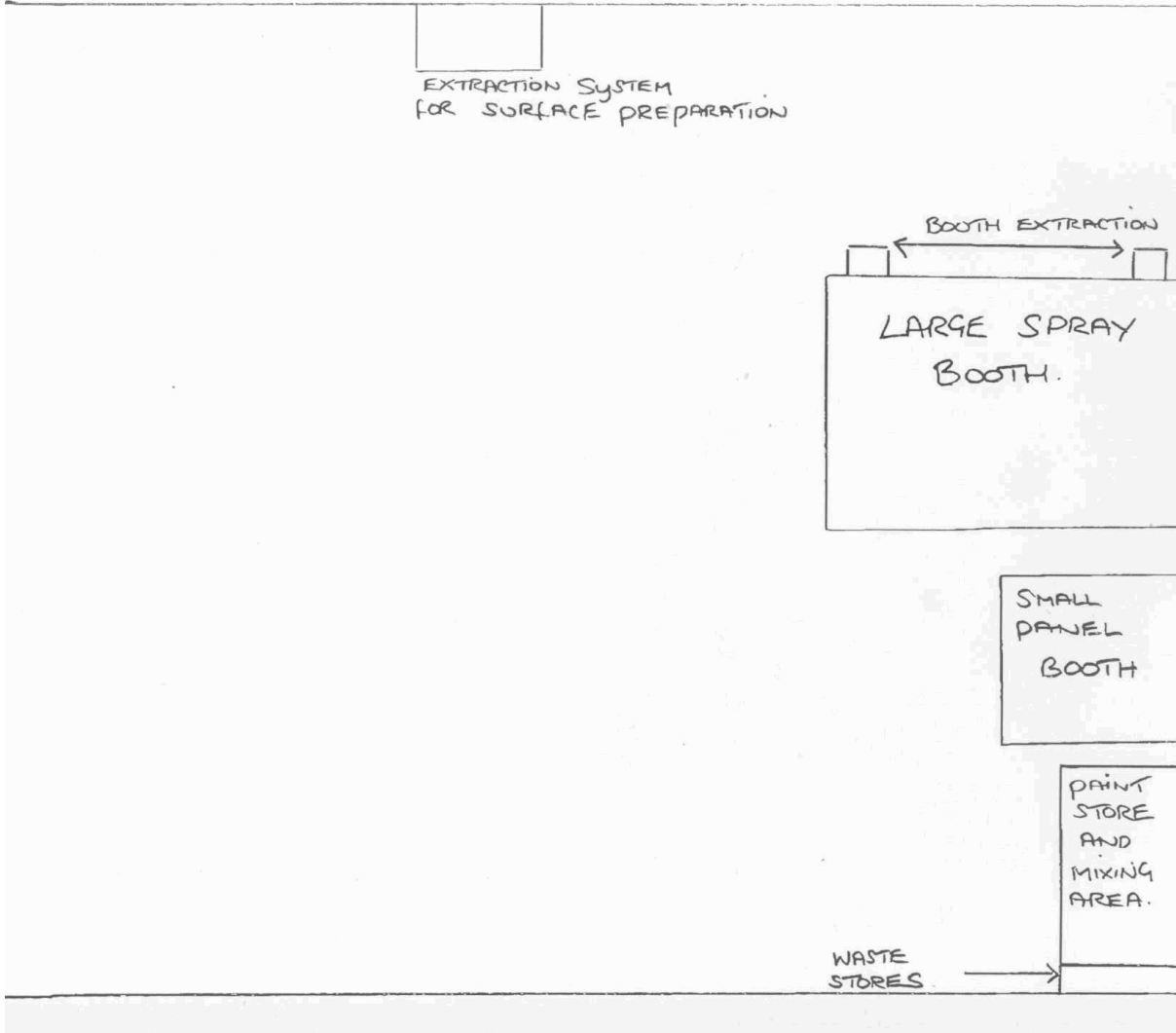

Schedule 3- Production Categories and Maximum, Application Ready VOC Contents

	Product Subcategory	Coatings	VOC g/l(*)
a	Preparatory and cleaning	Preparatory	850
		Pre-cleaner	200
b	Bodyfiller/stopper	Alltypes	250
C	primer	Surface / filler and general (metal) primer	540
		Wash primer	780
d	Topcoat	All types	420
e	Special finishes	All types	840
(*) g/l of ready for use product. Except for subcategory (a) any water content of the product ready for use should be discounted			

(As listed in Appendix 4 of Process Guidance Note 6/34 (11).)

Schedule 4- Individual body shop products covered by this permit

a	<p>'preparatory and cleaning' means products designed to remove old coatings and rust, either mechanically or chemically, or to provide a key for new coatings:</p> <ul style="list-style-type: none"> I. preparatory products include gunwash (a product designed for cleaning spray-guns and other equipment), paint strippers, degreasers (including anti-static types for plastic) and silicone removers; <p>'precleaner' means a cleaning product designed for the removal of surface contamination during preparation for and prior to the application of coating materials;</p>
b	<p>Bodyfiller/stopper' means heavy-bodied compounds designed to be applied to fill deep surface imperfections prior to the application of the surfacer/filler;</p>
c	<p>'primer' means any coating that is designed for application to bare metal or existing finishes to provide corrosion protection prior to application of a primer surfacer:</p> <ul style="list-style-type: none"> I. 'surfacers/filler' means a coating designed for application immediately prior to the application of topcoat for the purpose of corrosion resistance, to ensure adhesion of the topcoat, and to promote the formation of a uniform surface finish by filling in minor surface imperfections; II. 'general metal primer' means a coating designed for application as primers, such as adhesion promoters, sealers, surfacers, undercoats, plastic primers, wet-on-wet, non-sand fillers and spray fillers; <p>'wash primer' means coatings containing at least 0,5 % by weight of phosphoric acid designed to be applied directly to bare metal surfaces to provide corrosion resistance and adhesion; coatings used as weldable primers; and mordant solutions for galvanised and zinc surfaces;</p>
d	<p>'topcoat' means any pigmented coating that is designed to be applied either as a single-layer or as a multiple-layer base to provide gloss and durability. It includes all products involved such as base coatings and clear coatings:</p> <ul style="list-style-type: none"> I. 'base coatings' means pigmented coatings designed to provide colour and any desired optical effects, but not the gloss or surface resistance of the coating system; <p>'clear coating' means a transparent coating designed to provide the final gloss and resistance properties of the coating system;</p>
e	<p>special finishes' means coatings designed for application as topcoats requiring special properties, such as metallic or pearl effect, in a single layer, high-performance solid-colour and clear coats, (e.g. anti-scratch and fluorinated clear- coat), reflective base coat, texture finishes (e.g. hammer), anti-slip, under-body sealers, anti-chip coatings, interior finishes; and aerosols.</p>
	<p><i>(As listed in Appendix 3 of Process Guidance Note 6/34 (11).)</i></p>

