



**POLLUTION PREVENTION AND CONTROL ACT 1999
ENVIRONMENTAL PERMITTING (ENGLAND AND WALES) REGULATIONS 2010
(amended)**

Permit Number: 3.1/050221/LT3

**Installation Address:
Right Mix Concrete Limited
Unit 6 Coleford Road
Darnall
Sheffield
S9 5PH**

In accordance with Regulation 13 of the Environmental Permitting (England and Wales) Regulations 2010 (amended), Right Mix Concrete Limited is hereby permitted to operate a scheduled activity at the address detailed above, namely blending cement in bulk or using cement in bulk other than at a construction site, including the bagging of cement and cement and mixtures, the batching of ready-mixed concrete as described in Schedule 1, Part 2, Chapter 3, Section 3.1, Part B, subsection (b) and subject to the following Permit

19TH April 2016

Signed: _____

Dated this day: _____

Assistant Manager

Authorised by Sheffield City Council to sign on their behalf

The Secretary of States Guidance PG 3/1(12) Blending, Packing, Loading and Use of Bulk Cement has provided the framework for the conditions in this Permit.

Name & Address of Operator:

Right Mix Concrete Limited
Unit 6 Coleford Road
Darnall
Sheffield
S9 5PH

Registered Office:

Right Mix Concrete Limited
Unit 6 Coleford Road
Darnall
Sheffield
S9 5PH

Address of Permitted Installation:

Right Mix Concrete Limited
Unit 6 Coleford Road
Darnall
Sheffield
S9 5PH

Contact: Matthew Latter Tel: 0114 2561660 (site)

alking to Us

Any communication with Sheffield City Council should be made to the following address quoting the Permit Number:

**Environmental Protection Service
Sheffield City Council
Howden House
5th Floor (North)
1 Union Street
Sheffield
S1 2SH**

Telephone: (0114) 273 4651
Fax: (0114) 273 6464
Email: ippc@sheffield.gov.uk

Contents

	page
Explanatory Note	4
Description of Activities	7
Section 1 Upgrades	8
Section 2 Emissions and Monitoring	8
Section 3 Silos	8
Section 4 Aggregates delivery and storage	9
Section 5 Belt Conveying	10
Section 6 Loading, unloading and transport	10
Section 7 Road and Transportation	10
Section 8 Technique to control fugitive emissions	10
Section 9 Records and Training	10
Section 10 Best available technique	11
Schedule 1 Table 1: Emission Limits, Monitoring and related provisions	12
Schedule 2 Installation Boundary	13
Schedule 3 Installation Layout	14
Schedule 4 Maintenance Programme	15
Schedule 5 Arrestment Plant Failure Plan	15
Schedule 6 List of Essential Spares	15
Schedule 7 Silo Filling Procedures	16

Explanatory Note to Pollution Prevention and Control Permit for Part B Installations.

(This note does not form a part of the Permit)

The following Permit is issued under Regulation 13 of the Environmental Permitting (England and Wales) Regulations 2010 (amended), (“the EP Regulations”) to operate an installation carrying out activities covered by the description in section 3, Chapter 1 of Schedule 1 of those Regulations, to the extent authorised by the Permit:

Process Changes

As part of your Permit you are required to notify the Council of any proposed change in operation at least 14 days before making the change. This must be in writing and must contain a full description of the proposed change in operation and the likely consequences. Failure to do so is an offence.

If you consider that a proposed change could result in the breach of the existing Permit conditions or is likely to require the variation of Permit conditions then you may apply in writing under Regulation 20(1) of the EP Regulations. Additionally, if this involves a SUBSTANTIAL CHANGE to the installation you will be required to submit an application, pay the relevant fee and advertise the application accordingly. You may serve a Notice on the Council requesting that they determine whether any change that is proposed would constitute a substantial change before you proceed with application.

Variations to the Permit

The Permit may be varied in the future (by the Council serving a Variation Notice on the Operator). If the Operator itself wants any of the Conditions of the Permit to be changed, a formal Application must be submitted.

Surrender of the Permit

Where the operator of a Part B installation or mobile plant ceases or intends to cease the operation of the activity the operator may notify the regulator of the surrender of the whole Permit, in any other case, notify the regulator of the surrender of the Permit in so far as it authorises the operation of the installation or mobile plant which he/she has ceased or intends to cease operating. The notification shall contain information as described in Regulation 24 or 25 of the EP Regulations.

Transfer of the Permit or Part of the Permit

Before the Permit can be wholly or partially transferred to another person, a joint application to transfer the Permit has to be made by both the existing and proposed holders, in accordance with Regulation 21 of the EP Regulations. A transfer will be allowed unless Sheffield City Council considers that the proposed holder will not be the person who will have control over the operation of the installation or will not ensure compliance with the conditions of the transferred Permit.

Annual Subsistence Fee

In accordance with the EP Regulations, the holder of a Permit is required to pay a fee for the subsistence of the Permit. This fee is payable annually on 1st April. You are advised that under the provisions of Regulation 65 (5) of the EP Regulations, if you fail to pay the fee due promptly, Sheffield City Council may revoke the Permit. You will be contacted separately each year in respect to this payment.

Public Register

The Council is required by Regulation 46 of the EP Regulations to maintain a Public Register containing information on all LAPPC installations and mobile plant. The register is available for inspection by the public free of charge during office hours (Monday to Friday 9.00 am to 5.00 pm) at the following address:

Environmental Protection Service
Sheffield City Council
Howden House
5th Floor (North)
1 Union Street
Sheffield
S1 2SH

Tel: 0114 273 4651

Confidentiality

Sheffield City Council has a duty to consider the question of confidentiality of information supplied to it. If any information supplied is considered confidential, a statement of which information this applies to and the reasons why it is considered confidential should be specified. The Operator is reminded that he may apply to Sheffield City Council for the exclusion of information from the public register under the provisions of the Environmental Permitting (England and Wales) Regulations 2007 as amended.

Appeals

Under Regulation 31 of the EP Regulations operators have the right of appeal against the conditions attached to their Permit. Schedule 6 of the EP Regulations sets out the detailed procedures.

Appeals against a Variation Notice do not have the effect of suspending the operation of the Notice. Appeals do not have the effect of suspending Permit conditions.

Notice of appeal against the conditions attached to the Permit must be given within six months of the date of the Notice, which is the subject matter of the appeal.

How to Appeal

There are no forms or charges for appealing. However, for an appeal to be valid, appellants (the person/operator making the appeal) are legally required to provide:

- Written notice of the appeal;
- A statement of the grounds of appeal;
- A statement indicating whether the appellant wishes the appeal to be dealt with by written representations procedure or a hearing - a hearing must be held if either the appellant or enforcing authority requests this, or if the Planning Inspector or the Secretary of State decides to hold one.
- (Appellants must copy the above three items to the local authority when the appeal is made)
- A copy of any relevant application;
- A copy of any relevant Permit;
- A copy of any relevant correspondence between the appellant and the regulator; and
- A copy of any decision or notice, which is the subject matter of the appeal.

Where to Send Your Appeal Documents

Appeals should be addressed to:

**The Planning Inspectorate
Environmental Appeals Administration
Room 4/19 - Eagle Wing
Temple Quay House
2 The Square
Temple Quay
Bristol BS1 6PN**

In the course of an Appeal process the main parties will be informed of procedural steps by the Planning Inspectorate.

To withdraw an appeal the appellant must notify the Planning Inspectorate in writing and copy the notification to the local authority.

Description of Activities

The activity is conducted within the boundaries as indicated on the site location and layout shown in Schedules 2 and 3 of this Permit. The permitted activity involves the dry batching of ready mixed concrete. The description of the permitted activities includes all associated processes such as the delivery, storage and handling of cement and aggregates, loading of truck mixers and the dispatch of waste and final products.

Bulk cement and aggregates are delivered to site and the cement is transferred to 4 x 50 tonne enclosed silos. Cement is transferred from the base of the storage silo by a fully enclosed screw feeder to an enclosed cement weigh hopper. After weighing the cement is discharged to the truck mixer along with damp aggregates and sprayed with water. Small amounts of admixtures (plasticizers and air entrainers) may be included to modify the properties of the mix.

Cement deliveries are controlled by tanker drivers using compressors through sealed hoses to 4 silos of 50 tonne capacity. The silos are each fitted with Wameco reverse jet filters, high level alarms and pressure relief valves. During delivery displaced air through the silos are vented through filters emitting no more than $10\text{mg}/\text{m}^3$ of particulate to atmosphere.

Aggregate deliveries are made by lorries to the storage bays. Aggregate materials are taken to the hoppers in a loading shovel. Partially enclosed conveyor belts are used to transfer the aggregates to the batching area. The drop height is 1.5 metres through a rubber sock.

Truck mixers are loaded within the canopied loading area.

Conditions of Permit

You are required to comply with the conditions with immediate effect unless otherwise stated.

Section 1 – Upgrades

1.1 There are no upgrading conditions.

Section 2 – Emissions and Monitoring

2.1 No visible particulate matter shall be emitted beyond the installation boundary.

2.2 The operator shall keep records of inspections, test and monitoring, including all non-continuous monitoring, inspections and visual assessment. Records shall be:

- Kept on site;
- Kept by the operator for at least two years; and
- Made available for the regulator to examine.

2.3 The emission requirements and methods and frequency of monitoring set out in Table 1, in Schedule 1, shall be complied with. Sampling shall be representative.

2.4 Any monitoring display required for compliance with the Permit shall be visible to operating staff at all times. Corrective action shall be taken immediately if any periodic monitoring results exceed a limit in Table 1, or if there is a malfunction or breakdown of any equipment which might increase emissions. Monitoring shall be undertaken or repeated as soon as possible thereafter and a brief record shall be kept of the main actions taken.

2.5 All plant and equipment capable of causing, or preventing, emission and all monitoring devices shall be calibrated and maintained in accordance with the manufacturing instructions. Records shall be kept on such maintenance.

Section 3 - Silos

3.1 Bulk cement and cementitious materials shall only be stored inside the four 50 tonne silos.

3.2 Dust emissions from loading or unloading road tankers shall be minimised by venting to reverse jet filters or back venting to a delivery tanker fitted with an on-board, truck- mounted relief valve and filtration system and by connecting transfer lines first to the delivery inlet point and then to the tanker discharge point, and by ensuring delivery is at a rate which does not pressurise the silos.

-
- 3.3 Silos and bulk containers of dusty materials shall not be overfilled and there shall be an overfilling alarm.
 - 3.4 Displaced air from pneumatic transfer shall pass through the reverse jet filters prior to emission to air.
 - 3.5 Bulk storage tanks and silos containing dry material shall be equipped with audible and/or visible high level alarm, to warn of overfilling. The correct operation of such alarm shall be checked in accordance with manufacturer's instructions. If manufacturer's instructions do not specify the frequency of inspection, then the check shall be weekly or before a delivery takes place, whichever is the longer interval.

Deliveries must automatically stop where over filling or over-pressurisation is identified.

- 3.6 If emissions of particulate matter are visible from ducting, pipe work, the pressure relief device or dust arrestment plant during silo filling, the operation shall cease; the cause of the problem shall be rectified prior to further deliveries taking place. Tanker drivers shall be informed of the correct procedure to be followed.
- 3.7 Seating of pressure relief devices on silos shall be checked at least once a week, or before a delivery takes place, which ever is the longer interval
- 3.8 Immediately it appears that the device has become unseated during silo filling, no further delivery should take place until corrective action has been taken. The pressure relief device shall be examined to check for defects before being reset and a replacement fitted if necessary. Tanker drivers shall be informed of the correct procedure to follow.

Section 4- Aggregates delivery and storage

- 4.1 Dusty materials shall only be stored within 3 sided storage bays and shall be subject to suppression and management techniques to minimise dust emissions.
- 4.2 Dusty waste shall be stored in a skip which shall be covered.
- 4.3 The Permit holder shall ensure that the storage bays are never overfilled. Spillages of aggregates outside these areas shall be cleared immediately.
- 4.4 When the capacity of the storage bays is not sufficient to contain all the materials, excess material shall be stored in appropriate locations and covered with sheets to prevent dust emissions.

Section 5- Belt conveying

- 5.1 The aggregate feed conveyor shall be totally enclosed to reduce wind whipping of dust.
- 5.2 Conveyors shall be fitted with effective means of keeping the return belt clean and for collecting materials removed by the cleaning operation.

Section 6- Loading, unloading and transport

- 6.1 No potential dusty materials (including waste) or finished products, shall arrive on or leave the site other than by use of sheeted vehicles to prevent airborne emissions.
- 6.2 Truck mixers shall be loaded in such a way as to minimise airborne dust emissions. If they are loaded with dry minerals, local dust control measures shall be provided.

Section 7- Roadways and Transportation

- 7.1 All areas where there is regular movement of vehicles shall have a consolidated surface capable of being cleaned. These surfaces shall be kept clean and in good repair.
- 7.2 Vehicles shall not track materials from the site onto the highway.

Section 8- Techniques to control fugitive emissions

- 8.1 The fabric of process building shall be maintained so as to minimise visible dust emissions.

Section 9- Records and Training

- 9.1 Written or computer records of all tests and monitoring shall be kept by the operator for at least **2 years**. They shall be made available for examination by the council. Records shall be kept of operator inspections, including those for visible emissions.
- 9.2 All staff whose functions could impact on air emissions from the activity shall receive appropriate training on hose functions. This shall include:
 - Awareness of their responsibilities under the Permit;
 - Steps that are necessary to minimise emissions during start-up and shutdown;
 - Actions to take when there are abnormal conditions, or accidents or spillages that could, if not controlled, result in emissions.

Schedule 1- Table 1: Emission limits, Monitoring and related provisions

Table 1 - Emission limits, monitoring and related provisions					
Row	Substance	Source	Emission limits/provisions	Type of monitoring	Monitoring frequency
1	Particulate matter	Whole Process	No visible airborne emission to cross the site boundary where harm or nuisance may be caused	Operator observations	At least daily
		Silo inlets and outlets (<i>for silos new since 1st July 2004</i>)	Designed to emit less than 10mg/m ³	Operator observations	At time of delivery
		Silo inlets and outlets	No visible emission		
		Arrestment equipment, or any point where dust contaminated air is extracted from the process to atmosphere, with exhaust flow >300m ³ /min. (other than silo arrestment plant)	50mg/m ³	Recorded indicative monitoring	Continuous
				*Isokinetic sampling	At least once to demonstrate compliance, then as necessary to provide a reference for the continuous indicative monitor.
		Arrestment equipment, or any point where dust contaminated air is extracted from the process to atmosphere, with exhaust flow >100m ³ /min. (other than silo arrestment plant)	No visible emission Arrestment equipment should be provided with a design guarantee that the equipment can meet 50mg/m ³	Indicative monitoring to demonstrate that the arrestment equipment is functioning correctly	Continuous
Arrestment equipment, or any point where dust contaminated air is extracted from the process to atmosphere, with exhaust flow <100m ³ /min. (other than silo arrestment plant)	No visible emission	Operator observation Or Indicative monitoring	At least daily Or Continuous		
2	Droplets, persistent mist and fume	All emissions to air (except steam and condensed water vapour)	No droplets, no persistent mist, no persistent fume.	Visual observations	*On start-up and on at least two more occasions during the working day*
Only emissions to atmosphere are required to comply with the emission limits within this table.					
Notes:					
All periodic monitoring results shall be checked by the operator on receipt and sent to the Council within 8 weeks of the monitoring being undertaken.					
a) The reference conditions for limits in Table 1 are: 273.1K, 101.3kPa, without correction for water vapour content, unless stated otherwise.					
b) All periodic monitoring shall be representative, and shall use standard methods.					
c) The emission limits do not apply during start-up and shut down. All emissions shall be kept to a minimum during these periods.					

Schedule 2 Installation Boundary

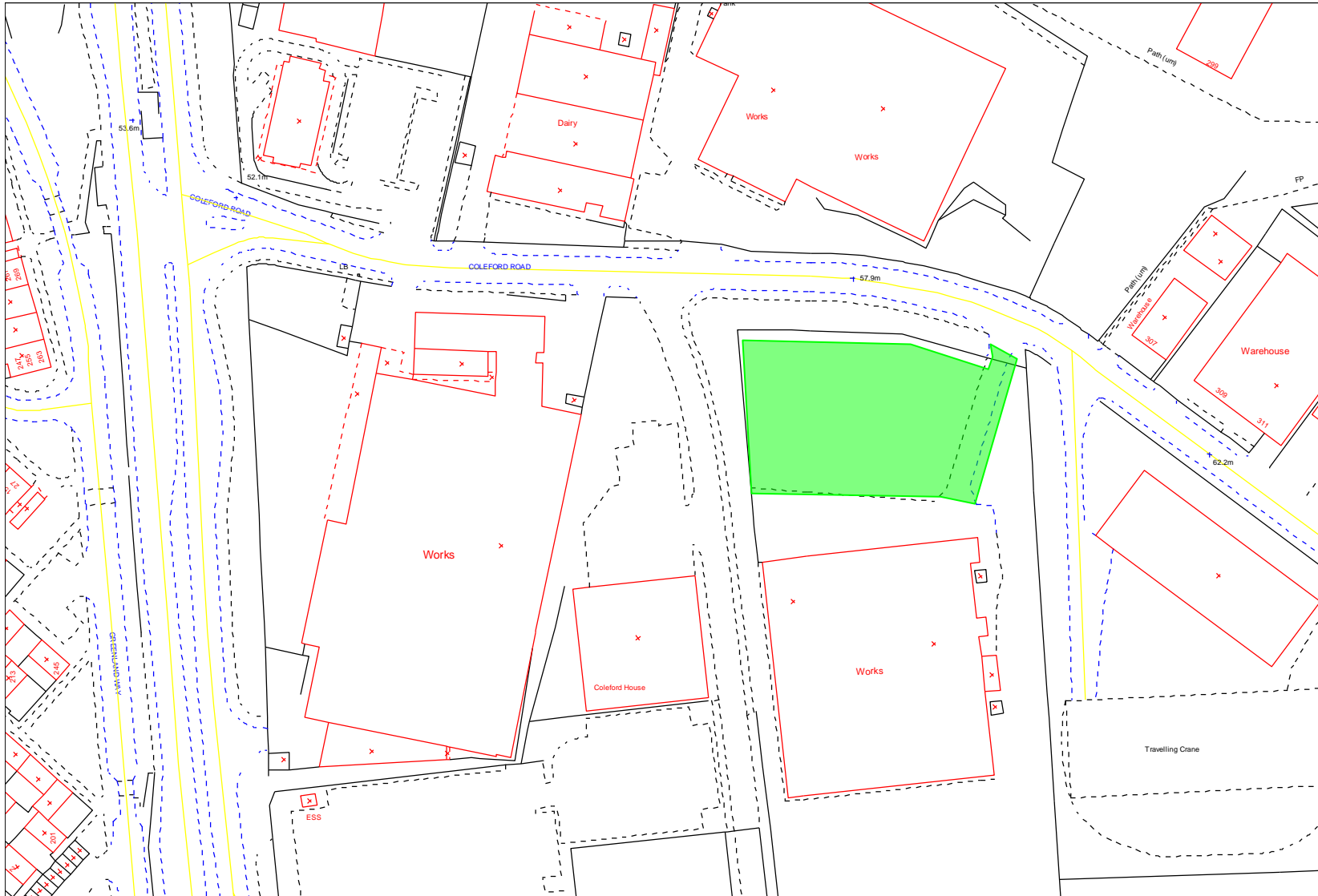

Schedule 3 Installation

Right Mix Concrete Ltd
Sims Layout plan: Scale 1:500

Concrete Barcoding Plant
Coleford Road, Daresbury, Salford

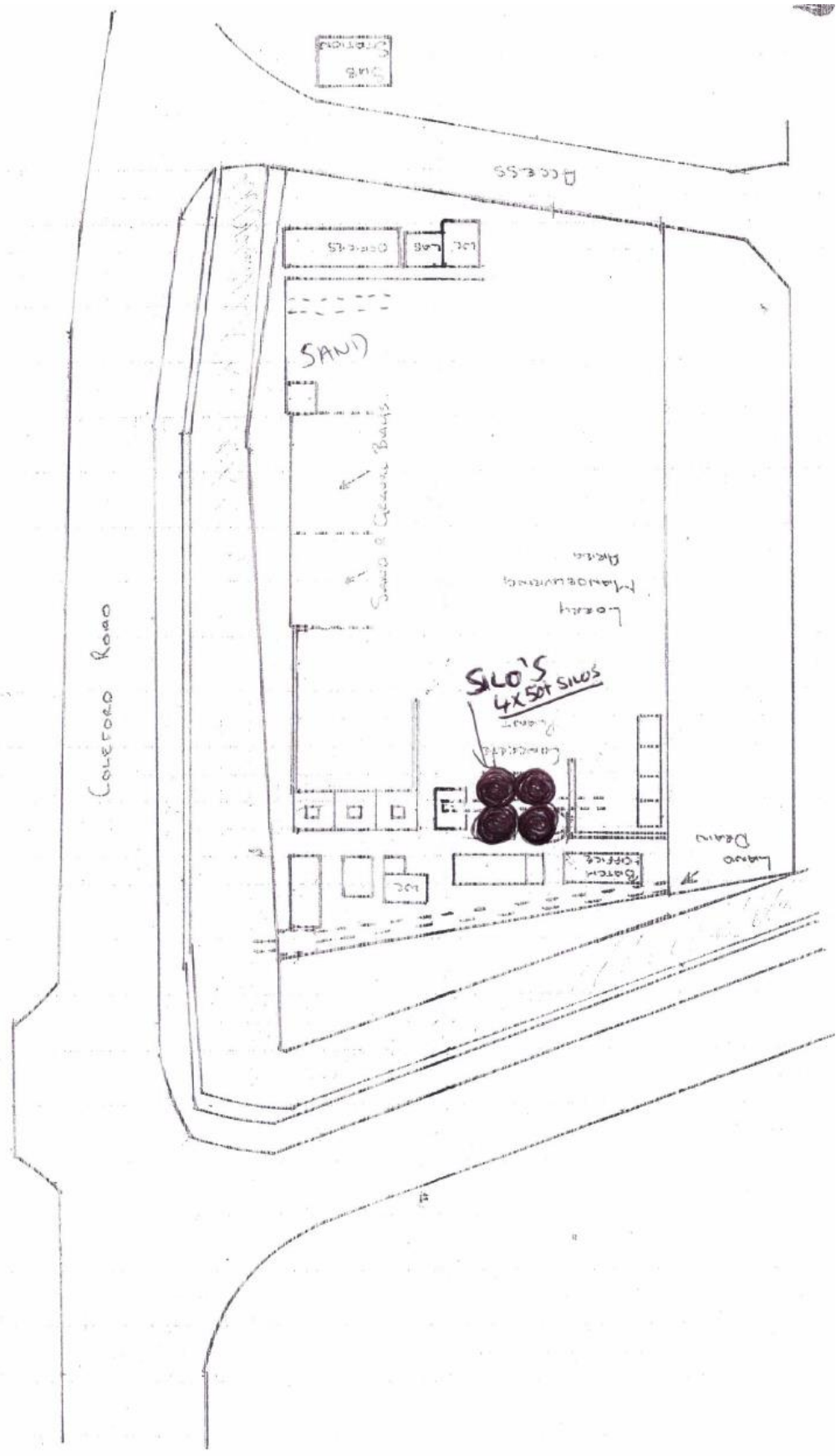

Schedule 4 - Maintenance Programme

Filters shall be checked 3 monthly and replaced at least 6 monthly.

Pipes and hoses shall be watched during materials transfer and repaired or replaced as necessary.

Sprinklers, Socks, Sheets and Boards shall be repaired or replaced as necessary to keep emissions to a minimum.

Conveyors shall be watched during operation and maintained as necessary.

Silo alarms shall be checked at least once a week or prior to a delivery of material, whichever period is greater.

Details of all repairs or replacements made to the equipment shall be recorded.

Schedule 5 - Arrestment plant failure plan

1. Stop the process.
2. Wait in a safe area until risk of danger has ceased.
3. Clean up any spillages using appropriate techniques.
4. Find the cause of the failure.
5. Take remedial action.
6. Test the effectiveness of the remedial action.
7. Observe and record: time, date of failure, description of the consequences of the failure, and details of remedial actions taken.
8. Notify Sheffield City Council's Environmental Protection Service of the incident.

Schedule 6 - List of Essential Spares

Spray heads

Pipes and pipe fittings

Silo filters

Conveyor sheeting

Hosepipe

Pressure air lines

Butterflies

Schedule 7 - Silo Filling Procedure

When a delivery of cement comes to the site the driver shall proceed to the designated area of the site. Usually at the side of the silos, dependant on the delivery.

The delivery driver shall then report to the RMC Plant Manager to notify him of the delivery and to obtain permission to connect the pipes. Once this has been done he confirms that the filters are open and all air valves are open then the dispatch of cement commences.

The Plant Manager shall keep constant supervision at all times and observe and register the cement indicator.

As a precaution water shall be added to the connection hoses to prevent any dust particles from escaping.

The delivery driver shall also observe and registers the tanker gages to ensure the correct pressure is applied enabling the load to be discharged correctly.

All batchers employed by RMC shall receive an intensive 6 week training period followed by a 2 week supervision period.