



**POLLUTION PREVENTION AND CONTROL ACT 1999
ENVIRONMENTAL PERMITTING (ENGLAND & WALES) REGULATIONS 2010
(As Amended)**

Permit Number: 2.2/048243/JT3

**Installation Address:
Orchid Orthopedic Solutions Sheffield Ltd
Parkway Close
Parkway Industrial Estate
SHEFFIELD
S9 4WH**

In accordance with Regulation 13(1) of the Environmental Permitting (England and Wales) Regulations 2010 as amended Orchid Orthopedic Solutions Sheffield Limited is hereby permitted to operate a scheduled activity at the address detailed above, namely the melting and making of non-ferrous metals in plant with a melting capacity of less than 20 tonnes per day, as described in Schedule 1, Part 2, Chapter 2, Section 2, Part B, a) and subject to the following Permit conditions.

Signed

Dated this day: 2nd April 2014

**Assistant Manager
Authorised by Sheffield City Council to sign on their behalf**

The Secretary of States Guidance PG 2/3 and PG 2/4 (13) have provided the framework for the conditions in this Permit.

Name & Address of Operator:

Orchid Orthopedic Solutions Sheffield Ltd
Parkway Close
Parkway Industrial Estate
Sheffield
S9 4WH

Contact: Sarah Roper : Tel: 0114 294 2456
Mob: 07876 834010
Fax: 0114 294 2301
Email: sarah.roper@orchid-ortho.com

Registered Office:

Orchid Orthopedic Solutions Sheffield Ltd
Parkway Close
Parkway Industrial Estate
Sheffield
S9 4WH

Company Registration number: 1090667

Address of Permitted Installation:

Orchid Orthopedic Solutions Sheffield Ltd
Parkway Close
Parkway Industrial Estate
Sheffield
S9 4WH

Talking to Us

Any communication with Sheffield City Council should be made to the following address quoting the Permit Number: **2.1/048243/JT3**

**ENVIRONMENTAL PROTECTION SERVICE
SHEFFIELD CITY COUNCIL
2-10 CARBROOK HALL ROAD
CARBROOK
SHEFFIELD
S9 2DB**

Alternatively Email: epsadmin@sheffield.gov.uk
Telephone: (0114) 273 4651
Fax: (0114) 273 6464

Contents

	page
Explanatory Note	4
Definitions	8
Description of Activities	10
Section 1 Upgrading	13
Section 2 Production Capacity	13
Section 3 Plant and Equipment	13
Section 4 Emission Limits and Controls	14
Section 5 Monitoring, Sampling and Measurement of Emissions	14
Section 6 Maintenance	18
Section 7 Materials Handling	20
Section 8 General Conditions	20
Schedule 1 Installation Location	22
Schedule 2 Layout 1	23
Schedule 2 Layout 2	24

Explanatory Note to Pollution Prevention and Control Permit for Part B Installations.

(This note does not form a part of the Permit)

The following Permit is issued under Regulation 13 of the Environmental Permitting (England and Wales) Regulations 2010 (S.I. 2010 No.675), as amended, (“the EP Regulations”) to operate an installation carrying out activities covered by the description in Section 2.2 Part B (a) of Schedule 1 of those Regulations, to the extent authorised by the Permit:

Process Changes

Under the provisions of the EP Regulations, you are required to notify the Council of any proposed change in operation at least 14 days before making the change. This must be in writing and must contain a full description of the proposed change in operation and the likely consequences. Failure to do so is an offence.

If you consider that a proposed change could result in the breach of the existing permit conditions or is likely to require the variation of permit conditions then you may apply in writing under Regulation 20(1) of the EP Regulations. Additionally, if this involves a SUBSTANTIAL CHANGE to the installation you will be required to submit an application, pay the relevant fee and advertise the application accordingly. You may serve a Notice on the Council requesting that they determine whether any change that is proposed would constitute a substantial change before you proceed with application.

Variations to the Permit

The Permit may be varied in the future by the Council serving a Variation Notice on the Operator. If the Operator wishes any of the Conditions of the Permit to be changed, a formal Application must be submitted.

Surrender of the Permit

Where the Operator of a Part A2 installation or mobile plant ceases or intends to cease the operation of the activity the Operator may notify the regulator of the surrender of the whole permit, in any other case, notify the regulator of the surrender of the permit in so far as it authorises the operation of the installation or mobile plant which he/she has ceased or intends to cease operating. The notification shall contain information as described in Regulation 24 or 25 of the EP Regulations.

Transfer of the Permit or Part of the Permit

Before the Permit can be wholly or partially transferred to another person, a joint application to transfer the Permit has to be made by both the existing and proposed holders, in accordance with Regulation 21 of the EP Regulations. A transfer will be allowed unless Sheffield City Council considers that the proposed holder will not be the person who will have control over the operation of the installation or will not ensure compliance with the conditions of the transferred Permit.

Annual Subsistence Fee

In accordance with Regulation 65 of the EP Regulations, the holder of a permit is required to pay a fee for the subsistence of the Permit. This fee is payable annually on 1st April. You are advised that under the provisions of Regulation 65 (5) of the EP Regulations, if you fail to pay the fee due promptly, Sheffield City Council may revoke the Permit. You will be contacted separately each year in respect to this payment.

Public Register

The Council is required by Regulation 46 of the EP Regulations to maintain a Public Register containing information on all LAPPC installations and mobile plant. The register is available for inspection by the public free of charge during office hours (Monday to Friday 9.00 am to 5.00 pm) at the following address:

Environmental Protection Service
Sheffield City Council
2-10 Carbrook Hall Road
Carbrook
Sheffield
S9 2DB

Tel: 0114 273 4651 or email epsadmin@sheffield.gov.uk

Confidentiality

Sheffield City Council has a duty to consider the question of confidentiality of information supplied to it. If any information supplied is considered confidential, a statement of which information this applies to and the reasons why it is considered confidential should be specified. The Operator is reminded that he may apply to Sheffield City Council for the exclusion of information from the public register under the provisions of the Environmental Permitting (England and Wales) Regulations 2010 as amended.

Appeals

Under Regulation 31 of the EP Regulations Operators have the right of appeal against the conditions attached to their permit. Schedule 6 of the EP Regulations sets out the detailed procedures.

Appeals against a Variation Notice do not have the effect of suspending the operation of the Notice. Appeals do not have the effect of suspending Permit conditions.

Notice of appeal against the conditions attached to the permit must be given within six months of the date of the Notice, which is the subject matter of the appeal.

How to Appeal

There are no forms or charges for appealing. However, for an appeal to be valid, appellants (the person/Operator making the appeal) are legally required to provide:

- Written notice of the appeal;
- A statement of the grounds of appeal;
- A statement indicating whether the appellant wishes the appeal to be dealt with by written representations procedure or a hearing – a hearing must be held if either the appellant or enforcing authority requests this, or if the Planning Inspector or the Secretary of State decides to hold one.
- (Appellants must copy the above three items to the local authority when the appeal is made)
- A copy of any relevant application;
- A copy of any relevant permit;
- A copy of any relevant correspondence between the appellant and the regulator; and
- A copy of any decision or notice, which is the subject matter of the appeal.

Where to Send Your Appeal Documents

Appeals should be addressed to:

**The Planning Inspectorate
Environmental Appeals Administration
Room 4/19 – Eagle Wing
Temple Quay House
2 The Square
Temple Quay
Bristol BS1 6PN**

In the course of an Appeal process the main parties will be informed of procedural steps by the Planning Inspectorate.

To withdraw an appeal the appellant must notify the Planning Inspectorate in writing and copy the notification to the local authority.

Enforcement

An **Enforcement Notice** may be served if the Local Authority believes an Operator has contravened, is contravening or is likely to contravene any condition of his Permit.

A **Suspension Notice** may be served if in the opinion of the Local Authority the operation of an installation involves an imminent risk of serious pollution. This applies whether or not the Operator has breached a Permit condition.

The Local Authority can revoke a Permit by written notice at any time by serving a **Revocation Notice**. The Permit then ceases to authorise the operation of the installation.

Offences

A limited summary of the offences is listed below:

- a) operation of an installation without a Permit
- b) failure to comply with or contravene a Permit condition
- c) failure to comply with the requirements of an enforcement or suspension notice

A full list is available under Regulation 38 of the Environmental Permitting (England & Wales) Regulations 2010 as amended.

Penalties

The maximum penalties for the above offences are a fine not exceeding £50,000 and/or up to twelve months imprisonment per offence for a summary conviction (in a Magistrates Court); and a fine and/or up to five years imprisonment for conviction on indictment (in a Crown Court).

Definitions

In relation to this Permit, the following expressions shall have the following meanings:

“Application” means the application for this Permit, together with any response to a notice served under Schedule 4 to the EPR Regulations and any operational change agreed under the conditions of this Permit.

“EPR Regulations” means the Environmental Permitting (England and Wales) Regulations S.I.2010 No. 675 (as amended) and words and expressions defined in the EPR Regulations shall have the same meanings when used in this Permit save to the extent they are explicitly defined in this Permit.

“Permitted Installation” means the activities and the limits to those activities described in this Permit.

“Monitoring” includes the taking and analysis of samples, instrumental measurements (periodic and continual), calibrations, examinations, tests and surveys.

“Regulator” means any officer of Sheffield City Council who is authorised under section 108(1) of the Environment Act 1995 to exercise, in accordance with the terms of any such authorisation, any power specified in Section 108(1) of that Act.

“BAT” means the most effective and advanced stage in the development of activities and their methods of operation which indicates the practical suitability of particular techniques for providing in principle the bases for emission limit values designed to prevent, and where that is not practical, generally to reduce emissions and the impact on the environment as a whole. For those purposes:

“available techniques” means those techniques which have been developed on a scale which allows implementation in the relevant industrial sector, under economically and technically viable conditions, taking into consideration the cost and advantages, whether or not the techniques are used or produced inside the United Kingdom, as long as they are reasonably accessible to the Operator;

“best” means, in relation to techniques, the most effective in achieving a high general level of protection of the environment as a whole; *“techniques”* include both the technology used and the way in which the installation is designed, built, maintained, operated and decommissioned. Schedule 2 of the Regulations shall have effect in relation to the determination of best available techniques, and;

“Fugitive Emission” means an emission to air from the permitted installation that is not controlled by an emission limit imposed by a condition of this Permit.

Where any condition of this Permit refers to the whole or parts of different documents, in the event of any conflict between the wording of such documents, the document with the most recent publication date shall be taken to be the most appropriate document to be used.

DESCRIPTION OF ACTIVITIES

Orchid Orthopedic Solutions Sheffield Limited is an investment casting foundry that produces specialist castings such as medical components, parts for the aerospace industry and turbo wheels.

The activities in the installation are as follows:

Wax Pattern Manufacturing

Wax pellets are received and stored in bags before being melted and fed into a molten wax holding tank. Molten wax is then injected under pressure into a die to produce wax patterns, gates and runner systems from the injection moulding machine.

Wax fumes from the process are fugitive within the wax pattern manufacturing area and are not extracted to the external air.

Shell/Mould Manufacture

The wax assemblies are cleaned and etched with Trisol prior to being coated with a series of layers of a ceramic shell, by soaking the mould in a water based ceramic slurry and coating it with a fine refractory zirconia sand upon the wet surface and then left to dry prior to re-coating. The layers become progressively coarser using molochite refractory sands to produce a ceramic shell. The shelling process is either manually or robotically applied in a temperature and humidity controlled environment.

Powders and sands used in this process are received and stored in sealed bags.

There are 3 automated rainsanders, the particulate matter emissions from which are extracted to Dust Environmental (Engineering) Limited bag filters in 3 banks which are exhausted externally to atmosphere. The stack is located as indicated by S1 on the Layout 2 plan on page 24 of this Permit. A pressure drop indicator monitors the performance of the bag filters which is manually checked and recorded by personnel. The manual rainsander and hand grinders for shell removal are vented to an Airmaster bag filter, the emissions from which discharge internally.

De-Waxing

The wax inside the ceramic shell is removed using high pressure steam in an autoclave operating at 180°C. Steam from this process is exhausted to atmosphere. There are 3 stacks serving the autoclave, 2 of which emit residual steam, and one steam at high pressure.

Traces of wax remaining after autoclaving are removed by firing off in a fire off de-wax furnace which is fitted with an afterburner. Emissions to atmosphere are through the stack located at S2 as indicated on the Layout 2 plan on page 24 of this Permit. The moulds are loaded into the first chamber of the fire off furnace which operates at 900°C. Wax is fired off and travels to the secondary chamber where it is subjected to heat from the afterburner that operates at 950°C. The furnace and afterburner are fitted with a temperature monitor with a visual display panel and staff are trained in the written procedure as to when the moulds can be loaded.

There is a limitation set on the de-wax furnace such that the appliance can not be overloaded. This limitation equates to 2kg of wax per batch, which corresponds to 4 turbo moulds and 12 medical moulds.

The afterburner stack is fitted with a Codel opacity meter which activates an alarm when the obscuration level achieves 20% or more. These alarm events are automatically recorded on the computer system. The airflow through this stack is less than 150 m³/min and therefore not required to be stack tested.

Pre-Heat

Moulds are pre-heated in one of four gas-fired pre-heat ovens prior to pouring. Products of combustion emissions from this are exhausted directly to atmosphere.

Melting and Casting

The production of non-ferrous alloy cast moulds using both air melt and vacuum electric induction furnaces as listed below;

1 x Leybold-Heraeus Vacuum Induction Furnace with a 25kg capacity with dry pump.

1 x General Vacuum Equipment Induction Furnace with a 25kg capacity with oil pump.

2 Inductotherm Electric Induction Furnaces (air melt) with a capacity of 30kg each (rollover).

Casts are produced from, nickel, cobalt and chromium plus feeder compounds to produce specialist superalloys. Emissions from the air melt melting and casting process are not served with extraction, fumes from this process being fugitive within the foundry.

Emissions from the vacuum induction furnaces are extracted through the furnace extraction with no abatement through the stack(s) labelled S3 & S4a, S4b and S4c on the Layout 2 plan on page 24 of this Permit.

Knock out and Cleaning

The ceramic shell is removed from the castings by hand and by knock out, shotblast and grit blast. Cleaning works such as the removal of runners from the castings are carried out in a number of cutting, grinding and shotblasting machines. These operations are carried out in sealed cabinets which are served by individual extraction systems which do not vent to the external air but vent internally.

Finishing Operations

Castings are finished on multiple belt grinder machines. The emissions from these machines are extracted through individual bag filter units which vent internally.

Castings which contain ceramic cores are subject to chemical leach treatment in baths of potassium hydroxide with steam agitation to remove the core from the castings. Potassium hydroxide vapours are extracted directly to atmosphere.

Non Destructive Testing

Castings are immersed in a bath of fluorescent penetrant dye which is then drained and washed off. A small number of castings are etched with nitric and hydrochloric acid to enhance this process. These activities take place in the laboratory fume cupboard. Trivial concentrations of nitric acid and other emissions are extracted directly to atmosphere with no abatement.

Castings are x-rayed and inspected and any defects found will be removed by fettling or blasting.

Finished castings are then despatched.

This Permit covers the receipt, storage, handling and transporting of raw materials and the treatment and storage of waste materials on site.

CONDITIONS OF PERMIT.

The following conditions shall be complied with immediately unless otherwise stated.

Section 1 – Upgrading.

- 1.1 There are no Upgrading requirements.

Section 2 – Production Capacity.

- 2.1 The installation shall have a melting capacity of less than twenty tonnes per day.
- 2.2 Records of melting that demonstrate compliance or otherwise with condition 2.1 of this Permit shall be kept on site for a period of at least 2 years, and shall be made available to Sheffield City Council's Environmental Protection Service upon request.

Section 3 – Plant and Equipment.

- 3.1 The activities at the installation shall be carried out within the boundary outlined in red as indicated on the installation location and boundary plan in Schedule 1 of this Permit.
- 3.2 Permitted activities shall only be carried on using the plant and equipment as detailed in the Description of Activities and on the Installation Layout 1 and 2 reproduced on pages 23 and 24 of this Permit.
- 3.3 The Operator shall ensure that Sheffield City Council's Environmental Protection Service is notified of any proposed operational changes including any alterations to the process involving the provision of new plant or equipment which may affect emissions. The information shall be submitted at least 14 days before the changes take place.
- 3.4 No plant or equipment used for any activity shall be operated with an extraction point direct to atmosphere unless specifically noted within this Permit or specifically agreed in writing with Sheffield City Council's Environmental Protection Service.

Section 4 – Emission Limits and Controls.

- 4.1 All emissions to air, other than steam or condensed water vapour shall be free from persistent visible emissions and free from droplets.
- 4.2 Emissions to air shall be free of offensive odour beyond the installation boundary as perceived by an Authorised Officer from Sheffield City Council's Environmental Protection Service.
- 4.3 All emissions to air, including fugitive emissions, arising in normal operating conditions, including charging and pouring, shall be free from persistent visible emissions.
- 4.4 There shall be no burning in the open air in connection with the activities within the installation boundary.
- 4.5 The efflux velocity of emissions from the final point of discharge to atmosphere serving the emission points from the installation shall not be less than 15m/s.
- 4.6 Emissions from combustion processes shall be free from visible smoke and in any case shall not exceed the equivalent of Ringelmann Shade 1 as described in British Standard BS 2742:2009.
- 4.7 All reasonably practicable steps shall be taken to minimise the duration and visibility of emissions during start up and shut down.
- 4.8 The best available techniques shall be used to prevent or, where that is not practicable, reduce emissions from the installation in relation to any aspect of the operation of the installation which is not regulated by any other condition of this Permit.

Section 5 – Monitoring, Sampling and Measurement of Emissions.

- 5.1 The Operator shall ensure that a visual assessment of fugitive fume from the building housing the melting process is carried out at least once a day when molten metal is being cast from the air melt induction furnaces. The duration of the assessment shall be for a minimum of one minute. All results of observations shall be recorded in accordance with condition 5.15 of this Permit.

- 5.2 The Operator shall ensure that a visual assessment of emissions from the stack(s) serving the pumps to the vacuum induction furnaces is carried out when they are drawing down to vacuum. The duration of the assessment shall be for a minimum of one minute and shall coincide with the vacuum formation process. Details of the observations shall be recorded in accordance with condition 5.15 of this Permit.
- 5.3 Emissions of total particulate matter from the stack serving the Shell Firing shall be tested at least once in every 2 year period in order to determine compliance with the emission limit of 20mg/m³.
- 5.4 Emissions of total particulate matter from any stack with an airflow of 150m³/min or more of air shall be tested at least once in every twelve month period in order to determine compliance with the emission limit of 20mg/m³.
- 5.5 Prior to undertaking any emissions monitoring the Operator shall submit an emissions site monitoring protocol detailing the pollutants to be tested, stacks to be tested, the methods to be used and the proposed date of testing, at least 7 days before the testing is to take place to Sheffield City Council's Environmental Protection Service for approval in writing.
- 5.6 The results of annual non-continuous monitoring tests shall be forwarded to Sheffield City Council's Environmental Protection Service, within 8 weeks of completion of the testing.
- 5.7 Where the results of any non-continuous monitoring exceed the emission concentration limit, the Operator shall inform Sheffield City Council's Environmental Protection Service no later than 10:00 hours the following working day after receipt of the results of the emissions testing.
- 5.8 Stack emissions monitoring shall be carried out in accordance with methods described in M1 "Sampling requirements for monitoring stack emissions to air from industrial installations"¹ and M2 "Monitoring of stack emissions to air", or by another method agreed in writing by Sheffield City Council's Environmental Protection Service.

¹ The Environment Agency's Monitoring Certification Scheme <http://www.mcerts.net>

- 5.9 Non-continuous emissions monitoring of particulate matter shall be carried out in accordance with the main procedural requirements of BS ISO12141:2002 or BS EN 13284:Part 1 with averages taken over operating periods excluding start up and shut down. Sampling equipment should be capable of collecting particulate matter of 0.1 microns diameter or less, with an efficiency of at least 75%.
- 5.10 Results of non-continuous monitoring shall include details of process conditions at the time of monitoring, monitoring uncertainty and any deviations from the procedural requirements of standard reference methods and any error invoked from such deviations.
- 5.11 The monitoring reports shall record all pollutant concentrations expressed at reference conditions, 273K, 101.3kPa, the oxygen and water references shall be that which correspond to the normal operating conditions in the process concerned
- 5.12 Emissions of total particulate matter from the stack serving the fire off furnace shall be continuously indicatively monitored and shall trigger an audible and visible alarm when the emissions reach the equivalent reference level of 15mg/m³.
- 5.13 The Operator shall inform Sheffield City Council's Environmental Protection Service immediately in cases where:
- An emission is likely to have an effect on neighbouring premises; or
 - There is a failure of any arrestment plant.

The report to Sheffield City Council's Environmental Protection Service shall include:

- The date and time of the incident;
- The cause and nature of the incident;
- Details of any abnormal emissions;
- Details of remedial action taken.

- 5.14 In the event of results from any monitoring activity demonstrating a breach of emission limit or other condition of Permit, the Operator shall undertake the following actions:
- Cease the activity or process causing the breach immediately;
 - Investigate the cause immediately;
 - Carry out corrective action as soon as is practicably possible;
 - Record in the recording system required by condition 5.15 as much detail as possible regarding the cause and extent of the problem and the action taken to rectify the situation;
 - Undertake emissions re-testing to demonstrate compliance as soon as possible;
 - Only re-start the activity in question when it is compliant with emission limits and Permit requirements;
 - Notify Sheffield City Council's Environmental Protection Service within one day of becoming aware of the results.
- 5.15 The Operator shall ensure that records containing the details and results of all visual assessments and records of all inspections and observations made in accordance with Permit conditions is kept. These records shall include the time and date of inspection, the nature, colour, persistency and intensity of any emission and the name of the person carrying out the assessment. The records shall be kept on the permitted premises and made available for inspection by authorised officers of Sheffield City Council's Environmental Protection Service. Such records shall be kept for a minimum of two years and shall be submitted to in writing to Sheffield City Council on demand.
- 5.16 An annual summary of readings from the continuous monitor serving the stack to the fire off furnace S2 shall be submitted to Sheffield City Council's Environmental Protection Service once in every twelve month period. The next data shall be submitted by 14th January 2015 for the period 1st January to 31st December 2014 and shall include a record of alarm events, the duration of alarm events and actions taken to remedy the alarm condition.

Section 6 – Maintenance.

- 6.1 The Operator shall ensure that the opacity meter and associated alarm serving the afterburner stack on the de-wax furnace S2 is checked daily to ensure sound operation. Details of these checks shall be recorded in accordance with condition 5.15.
- 6.2 The opacity meter on the de-wax furnace afterburner shall be operated and maintained in accordance with manufacturer's recommendations and serviced at least once in every 12 month period. Details of the maintenance and servicing shall be recorded in accordance with condition 5.15 of this Permit.
- 6.3 The Operator shall ensure that the magnahelic gauge on the Dust Environmental (Engineering) Ltd bag filters is checked daily against a known safe operating parameter. Details of the checks shall be recorded in accordance with condition 5.15.
- 6.4 The Operator shall ensure the Dust Environmental (Engineering) Ltd bag filter is operated and maintained in accordance with manufacturer's recommendations and serviced at least once in every 12 month period. Details of the maintenance and servicing shall be recorded in accordance with condition 5.15.
- 6.5 The Operator shall ensure that a visual inspection of the Dust Environmental (Engineering) arrestment plant serving the automated rainsanders and associated ductwork is carried out at least once in every 2 month period under normal operating conditions for any signs of wear, tear or damage to ensure sound operation. Any damage or defects shall be repaired as soon as possible and all inspections including any remedial action taken shall be recorded in accordance with condition 5.15 of this Permit.
- 6.6 All continuous monitoring readings shall be on display to appropriately trained operating staff.
- 6.7 The Operator shall ensure that the continuous indicative monitors, magnehelic gauge, associated alarms and data loggers shall be checked as part of an ongoing written maintenance programme at least once a week to ensure sound operation. Details of these checks shall be recorded in the recording system kept in accordance with this Permit.
- 6.8 Buildings, housings and structures including roofs and guttering shall be inspected at least once per year for any signs of accumulations of dusty material that may become wind-whipped. Repairs and cleaning shall be carried out immediately and details of inspections shall be recorded in compliance with Condition 5.15 of this Permit.

- 6.9 Roadways, storage areas and yards shall be inspected at least once per month for any signs of accumulations of dusty material that may become wind-whipped. Cleaning shall be carried out immediately and details of inspections shall be recorded in compliance with condition 5.15 of this Permit.
- 6.10 An audit of items of plant and equipment shall be undertaken. The audit shall identify all plant and equipment that is critical to prevent, reduce or control emissions from the installation, including but not limited to the bag filters, after burner, alarms, detection systems and continuous monitors. A copy of the audit shall be submitted to Sheffield City Council's Environmental Protection Service for written approval within 8 weeks of the date of this Permit
- 6.11 A preventative maintenance schedule shall be produced for all critical plant and equipment identified from the audit required by condition 6.10. A copy of the maintenance schedule shall be submitted to Sheffield City Council's Environmental Protection Service for written approval within 8 weeks of the date of this Permit.
- 6.12 An adequate supply of spares and consumables shall be kept on site or made available within 1 day from guaranteed suppliers for all items of plant and equipment identified as being critical as a result of the audit carried out in compliance with condition 6.10.
- 6.13 For plant and equipment identified in the audit required by condition 6.10, alarms or other warning systems shall be provided as appropriate to indicate equipment malfunction or breakdown by a date agreed with Sheffield City Council's Environmental Protection Service.
- 6.14 The alarms or warning systems required by condition 6.13 for plant and equipment shall be checked as part of a preventative maintenance schedule and maintained in accordance with manufacturer's instructions. A record of such checks and maintenance shall be noted in the recording system kept in accordance with condition 5.15 this Permit.
- 6.15 Records of breakdowns and plant failure shall be kept and analysed in order to eliminate common failures. The records shall be made available for inspection by officers of Sheffield City Council's Environmental Protection Service on demand.
- 6.16 The Operator shall ensure that all abatement plant and associated detection systems, alarms and continuous monitors are maintained in good working order in accordance with manufacturer's recommendations as part of a written preventative Maintenance Programme.

- 6.17 The Operator shall ensure that all abatement plant, detection systems, alarms, continuous monitors and protection systems are serviced as appropriate at least once in every 12 month period by a competent person. Details of the maintenance shall be kept on site and made available for inspection by authorised officers of Sheffield City Council's Environmental Protection Service.

Section 7 – Materials Handling.

- 7.1 Arrested dust from the installation bag filters shall be collected directly into heavy duty bags lining the receptacles under the arrestment plant to prevent double handling of fines.
- 7.2 When full, the bags in the receptacles under the bag filter arrestment plant shall be tied or fastened securely and placed in a waste container in order to prevent emissions to atmosphere. Any split bags shall be double bagged.
- 7.3 Storage and handling of particulate matter including wastes shall be carried out in a manner so as to prevent or minimise dust emissions.
- 7.4 Spillages of potentially dusty or odorous materials shall be dealt with in accordance with a written Spill Procedure which is approved in writing by Sheffield City Council's Environmental Protection Service.
- 7.5 Cleaning operations shall be carried out by wet sweeping methods or vacuuming in order to minimise emissions of particulate matter to air.

Section 8 – General Conditions.

- 8.1 The stack serving the fire off de-wax furnace shall be adequately insulated to minimise cooling of waste gases and steam to prevent liquid condensation. Stacks and ductwork shall be leak proof.
- 8.2 Stacks or vents shall not be fitted with any restriction at the final opening to exit velocity such as a plate, cap or cowl other than an accelerator cone or low resistance cowl.
- 8.3 Staff at all levels shall receive training and instructions necessary for their duties and shall include the following:
- Responsibilities under the Permit;
 - Minimisation of emissions at start up and shut down;
 - Actions during abnormal emissions including minimisation of emissions.

- 8.4 The Operator shall keep and maintain a statement of training requirements for each operational post and keep a record of the training received by each employee whose actions may have an impact on emissions to atmosphere. These documents shall be made available to Sheffield City Council's Environmental Protection Service upon request.

Please Note.

Where complaint is attributable to the operation of the installation and is, in the opinion of the Local Authority, justified, or if new knowledge develops on the potential for harmful effects from emissions, an immediate review of the Permit shall be undertaken. The Local Authority shall subsequently specify any new requirements and compliance time scales.

An annual subsistence fee as prescribed by the Secretary of State for the Environment shall be payable, for this Permit, by the process Operator, to this Authority within 2 weeks of the 1st April of each year.

In the event that the Permit has been issued after the 1st April in the initial year then the subsistence fee shall be pro rata for the complete months remaining and shall be due within 2 weeks of the Permit issue date.

If the relevant payment is not received by Sheffield City Council's Environmental Protection Service then Permit revocation procedures shall be initiated in accordance with Section 22 of the Environmental Permitting (England & Wales) Regulations 2010 or any statutory re-enactment of the same.

The requirements of this Permit are not to be taken as planning permission. Where any structural alterations are necessary to ensure compliance with this Permit then the normal planning channels should be followed.

Installation Location and
Boundary
Schedule 1



LAYOUT 1

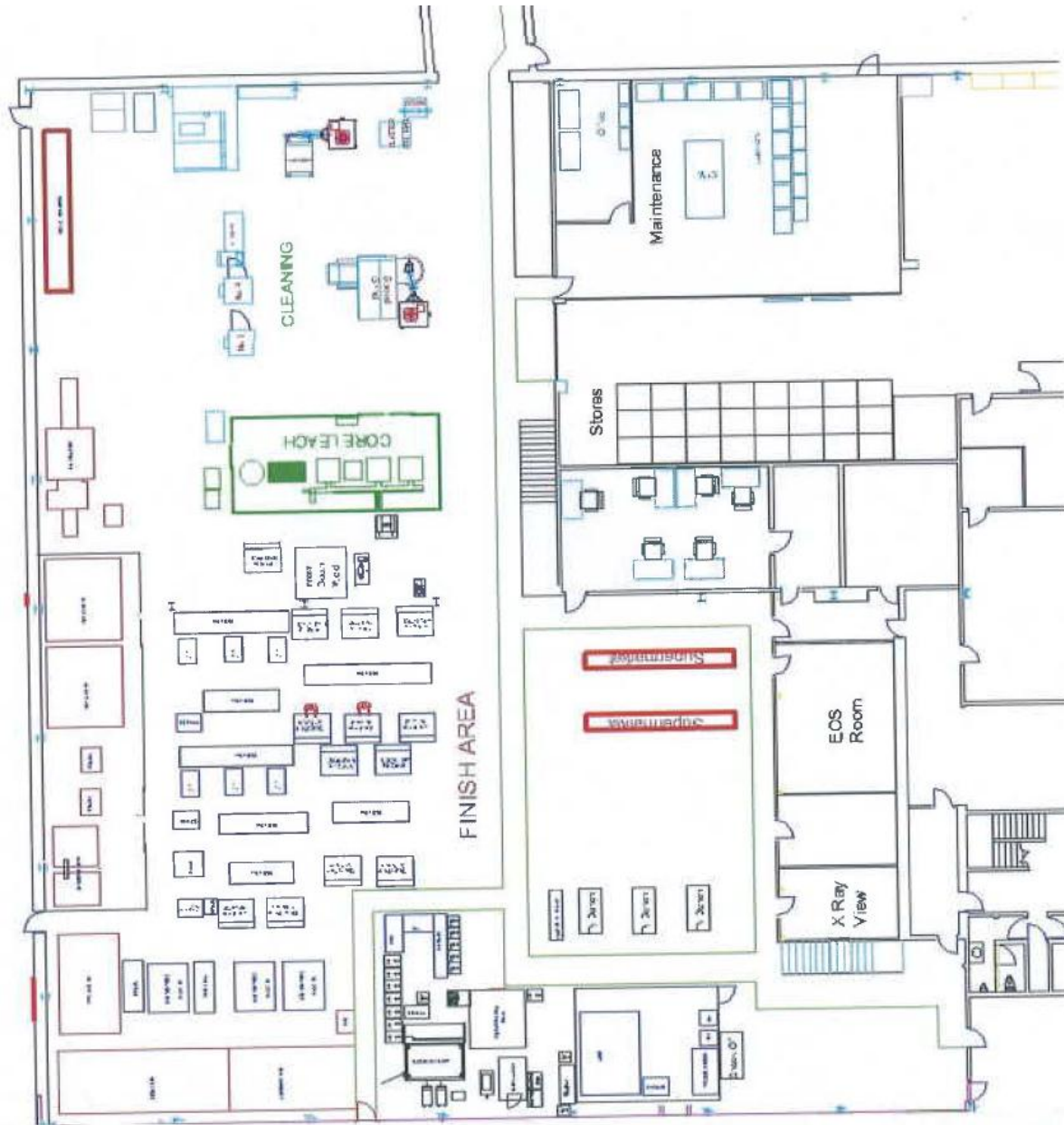

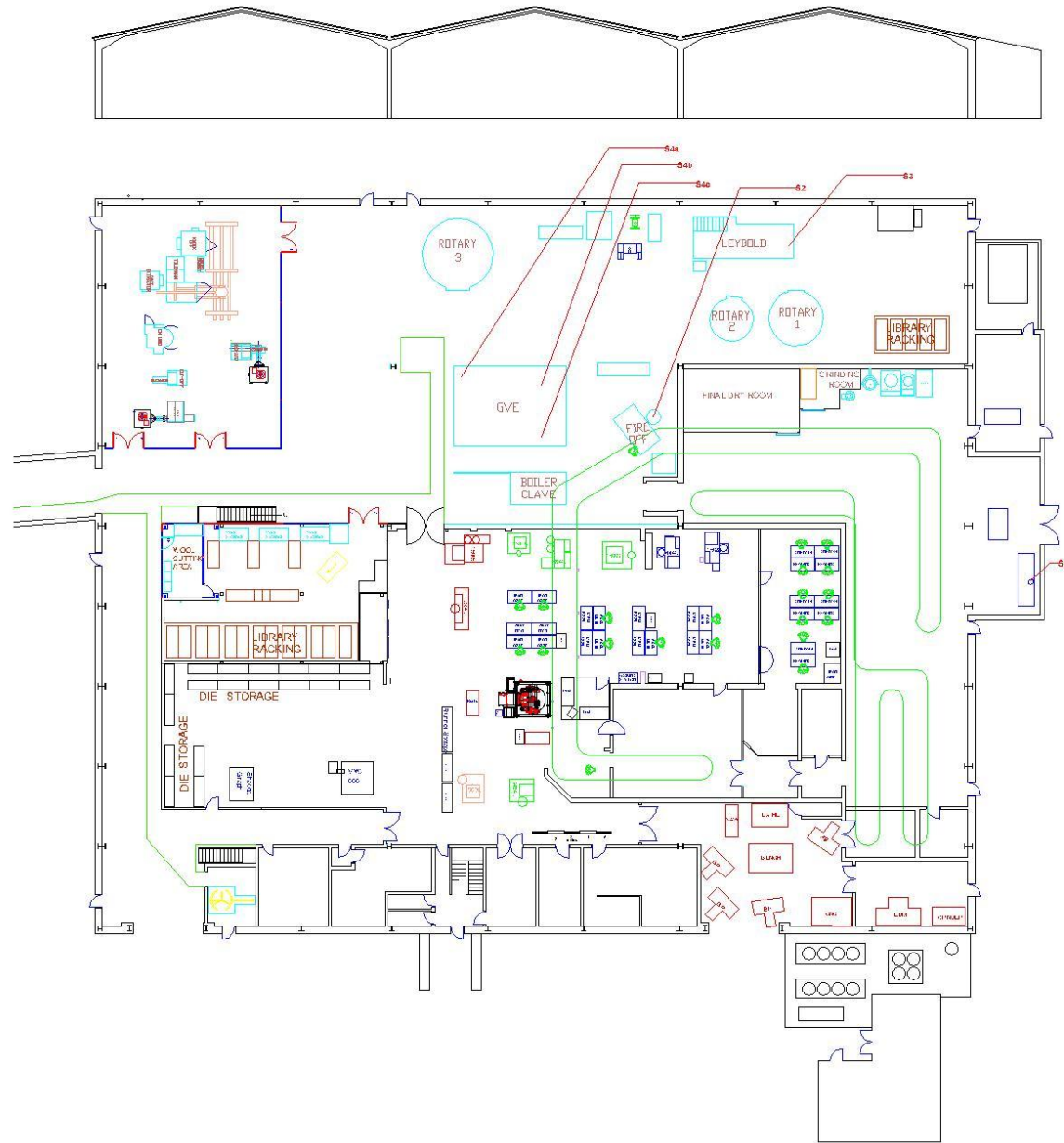

LAYOUT 2