

Sources for the Study of the History of Sheffield's Public Houses



© **Sheffield Libraries Archives and Information 2020-2022**

v. 1.1 Feb 2022

Front cover illustrations:

Punch Bowl Inn, Crookes, c. 1900
(*Sheffield Local Studies Library Picture Sheffield: s06984*)

Extract from receipt for the Tontine Inn, Haymarket, Sheffield, 1832
(*Sheffield Local Studies Library Picture Sheffield: s07060*)

Horse drawn bus (Joseph Tomlinson and Sons) outside the Sportsman Inn,
Barnsley Road, Pitsmoor, c. 1900
(*Sheffield Local Studies Library Picture Sheffield: s15285*)

Images can be copied for private or educational use without permission from us, though we ask that the following acknowledgement is included '[document reference number] From the collections of Sheffield Libraries Archives and Information'. Please contact us if you wish to publish, exhibit or broadcast any of the information within this *Guide*.

You can download a copy of this *Study Guide* from www.sheffield.gov.uk/archives

Contents

Introduction	4
Timeline showing some key events	5
List of documents, books, photographs and other items available at Sheffield Libraries, Archives and Information:	
• Street/Trade Directories	6
• Maps	6
• Licensing Records.....	8
• Architectural Plans	11
• Photographs/Images	12
• Newspaper Articles	12
• Sale Plans and Particulars	13
• Deeds.....	13
• Landed Estate Records.....	15
• Brewery Company Records	16
• Rating and Valuation Records.....	16
• Census Returns	16
• Other Miscellaneous Contemporary Documents.....	16
• Books and Publications	17
Library and archive collections held elsewhere.....	19
Sheffield Local Studies Library and Sheffield City Archives Facilities	20
Contact Details.....	21

Introduction

This booklet lists sources available within Sheffield Libraries Archives and Information for the study of the history of Sheffield's public houses or 'pubs'.

For centuries, pubs or public houses (also variously referred to as hotels, inns, taverns, etc.) have operated at the heart of social and community life in Sheffield. In earlier times, as coaching inns, they served as important transport hubs too. Over several hundred years, Sheffield's pubs have afforded not just opportunities for people to have a drink and socialise, but have also played host to singing, dancing, theatrical performances, public meetings, public auctions and even coroner's inquests. They were also the birthplace of many local friendly societies, clubs and unions.

Sheffield's earliest known named public house, which can be traced back to at least 1593, was the Cock situated on the High Street. By the mid 1700s, the Cock had closed but a number of other pubs had (at this point in time) become firmly established in Sheffield. These included prominent coaching inns, notably the Angel Inn, Angel Street, and the King's Head, Change Alley, which both served as key arrival and departure points for stagecoaches entering and leaving the town throughout the 18th and 19th centuries. Other well-known 18th-century pubs in Sheffield included the Blackamore Head, the Norfolk Arms (later became the Blue Bell and later Clarence House) and the Rose and Crown, all situated on the High Street, another Rose and Crown and the George and Dragon (later the Bodega), both situated on Market Place, and the Crown and Cushion (formerly the 'Assembly House', later became the Bull and Oak) on the Wicker.

In 1785, the Tontine Inn, Haymarket was built, another great coaching inn which became a major transport hub in Sheffield as well as a focal point for public meetings, protests and even riots. In 1787, there were 161 licensed victuallers (public houses with full licences to sell beer, wines and spirits) in Sheffield and many more alehouses/beerhouses (which were not permitted to sell spirits or wine). As Sheffield continued to expand throughout the 19th-century, so did its number of pubs to cater for the growing thirsty throngs of workers attracted by the town's burgeoning cutlery, metal and other manufacturing industries. By 1852, Sheffield (population 135,000) had 392 public houses and a further 335 alehouses. By 1900, Sheffield (population now in excess of 400,000) had amassed 514 public houses and 651 alehouses.

Fast forward to the end of the 20th-century and the number of pubs in Sheffield had fallen away. In 1990, even though the population of Sheffield now stood at over 500,000, there were 188 public houses and no alehouses remaining.

This *Guide* is not a detailed study of Sheffield pubs or their origins; it merely points the reader who wishes to carry out their own research to what is available within Sheffield Libraries and Archives. As more items are catalogued and the collections are used by researchers it is likely that additional references will come to light. More detailed searching of our catalogues for broader terms (such as inn, tavern, hotel, public house, etc., for example) may reveal additional material.

Timeline showing some key dates

1552	Act of Parliament passed requiring keepers of “alehouses and tiplinghouses” to have a licence in order to sell ale or beer.
1627	Premises built which became known as the Nailmakers Arms, Norton (and which became Sheffield’s oldest licensed public house).
1680	Angel Inn, Angel Street, Sheffield built (which became the town’s main transport hub).
1756	Public brewery in Sheffield (near the Grammar School at Townhead Cross) erected by Mr John Taylor.
1758	Thomas Rawson, a miller and tanner, opened a brewery on Pond Street, Sheffield (which became Thomas Rawson & Co. Ltd, Pond Street Brewery)
1785	Tontine Inn, Haymarket opened, another of Sheffield’s great coaching inns which became another major transport hub.
1790	Nine men put in the stocks “for tippling in a public house during Divine Service” in Sheffield.
1820	Exchange Brewery founded on Bridge Street, Sheffield (later acquired by Tennants Brothers in 1840)
1828	Alehouse Act passed, establishing a general annual licensing meeting to be held in every town, county and riding, for purposes of granting licences to inns, alehouses and victualling (i.e. provision of food) houses to sell excisable liquors to be drunk on the premises.
1830	Beerhouse Act passed, permitting any householder or rate payer to turn his house into a public house on payment of two guineas to the excise (with the intention of increasing competition, lowering prices and encouraging people to drink beer rather than strong spirits, especially cheap gin).
1841	One of the oldest domestic buildings in Sheffield on Pond Street (dating back to the 15 th -century) converted into a beerhouse by James Pilley, nail and rivet maker, becoming the Old Queens Head
1850	Tontine Inn, Haymarket, bought by the Duke of Norfolk and subsequently pulled down to make way for the new Norfolk Markets.
1872	Licensing Act passed, introducing restrictions on opening hours of public houses and allowing local authorities to determine licensing hours.
1940	Enemy air raids in December destroy various well-known and longstanding public houses in Sheffield which had been in existence since the 18 th -century and beyond, including: the Angel Inn, Angel Street, the King’s Head Change Alley, the Horse and Cat, High Street and the Bodega (formerly the George and originally the George and Dragon), Market Place.

List of documents, books, photographs and other items available at Sheffield Libraries, Archives and Information

Street/Trade Directories

Both Sheffield City Archives and Sheffield Local Studies Library hold series of Sheffield Street/Trade Directories dating back to 1787 (with the larger collection held at the Local Studies Library). Such directories are available to browse on the open shelves at both service points and are one of the most easily accessible sources for finding information

HOTELS, INNS, & TAVERNS. <i>See also Wine & Spirit dtrs.</i> Acorn, S. Wilson, 62, Shales moor Albion Tavern, Alfred Ward, Little Sheffield Albion Hotel, Wm. Travis, Hay- market All Nations, Edwin Bussey, 18, Water lane Ancient Pine Apple, Thos. Wil- kinson, 9, Radford row Angel Inn (& posting house), Ed- ward Hancock, 8, Angel st. Angel, Ellis Howe, 84, Westbar green Angel, Wm. Tomlinson, South st. Anvil, Jonth. Turner, 6, Waingt. Anvil, Eliz. Goodwin, 72, South street Arundel Castle, Thos. Knight, 39, Arundel street Ball, Wm. Petty, 56, Pond st. Ball, Esther Abbott, 8, Pea croft Ball, F. Bletcher, 104, Broad ln. Ball, Geo. Bray, 3, Lambert st. Ball, Saml. Fox, 44, Hawley croft Ball, Ellen Wilson, 55, Carver st. Ball, W. Atkinson, 3, Norfolk st. Ball, J. Atley, 11, Spring street Ball, Jas. Eyre, 2, Green lane Ball, John Wolstenholme, 21, Osborne street Ball, I. Marshall, 48, Campo ln.	Barrel, R. Evinson, 5, Water ln. Barrel, T. Pinder, 2, Ltl. Pond st. Barrel, Wm. Holme, 13, Pond st. Barrel, Thos. Wood, Little Shef- field Barrel, T. Simpson, 112, Duke street, Park Bay Childers, Mrs. Eels, 7, High street Bay Childers, John Henson, 4, Bridge street Bay Horse, (Old) Wm. Wragg, 27, Westbar green Bay Horse, J. Leanox, Pitsmoor Bay Horse, Thos. Bagshaw, 83, South street Bazaar Hotel, John Pritchard, South street Bee Hive, T. Wild, Portland pl. Ben Lomond Tavern, Robert A. Smith, 11, Eyre street Birmingham Arms, Wm. Chap- man, 15, Lambert street Black Bull, J. Wilson, 40, Hol- lis croft Black Horse, Jerh. Copley, 9, Allen street Black Horse, Saml. Hibberd, 3, Howard street Black Lion, Geo. Greaves, 10, Bank street Black Lion, John Monkhouse, Snighill Black Rock, John Fordham, 7,
---	---

about Sheffield's pubs and their landlords/landladies in the past. Local street/trade directories, dating from the early 1800s, generally include an alphabetical *trades* section which will include separate alphabetical lists of "Inns" and also "Taverns and Public Houses". From the 1830s onwards, such directories generally include a single alphabetical list of "Hotels, Inns and Taverns" in the alphabetical trades section. Such listings (for a given year) include the *name of each premises, name of the licensee and address.*

Extract of alphabetical listing of "Hotels, Inns and Taverns" in Sheffield from William White's Directory of Sheffield, 1833

(Sheffield City Archives and Local Studies Library: Sheffield Street/Trade Directories)

Maps

Both the City Archives and the Local Studies Library hold collections of large-scale local **Ordnance Survey (OS) Maps** dating back to 1853 (with the larger collection held at the Local Studies Library) which can be produced on request at both service points. OS maps can be used in conjunction with street/trade directories (mentioned above) to enable the identification of the precise locations of individual public houses and get a sense of the neighbourhood where they were located. For example, using street/trade directories and OS maps together will reveal other businesses/industries and particular buildings located on the same street or neighbouring streets as a particular public house at a specific point in time.

Although not as extensive in coverage as OS maps, and only covering a much narrower time-frame, both the City Archives and the Local Studies Library also hold series of **Goad Fire Insurance Plans** mostly dating from 1896 (but with some plans resurveyed and reissued at later dates) (*Sheffield City Archives: SY674; Sheffield Local Studies Library: Goad Plans: 912.4274 SSTF*). These plans (which only cover central Sheffield) were produced by a London-based civil engineer, Charles E. Goad, as an aid to assessing fire insurance premiums, and can show useful detail for individual buildings, such as internal divisions of properties, staircases, glass and wooden roofs, water supply, etc.

Both the City Archives and the Local Studies Library also hold *earlier* series of **printed town maps of Sheffield**, dating back to 1736, the bulk of which have been digitised and are available to consult on our Picture Sheffield website www.picturesheffield.com. Although not

as detailed, or as large a scale, as the OS maps and Goad plans (mentioned above) some of these printed town maps show the locations of notable public houses in Sheffield, for example the map below, dating from 1808, which includes reference to Sheffield's great coaching inns (and key transport hubs) at the time: the *Angel Inn*, *Angel Street*, the *Tontine Inn*, *Haymarket*, and the *King's Head Inn*, *Change Alley*.

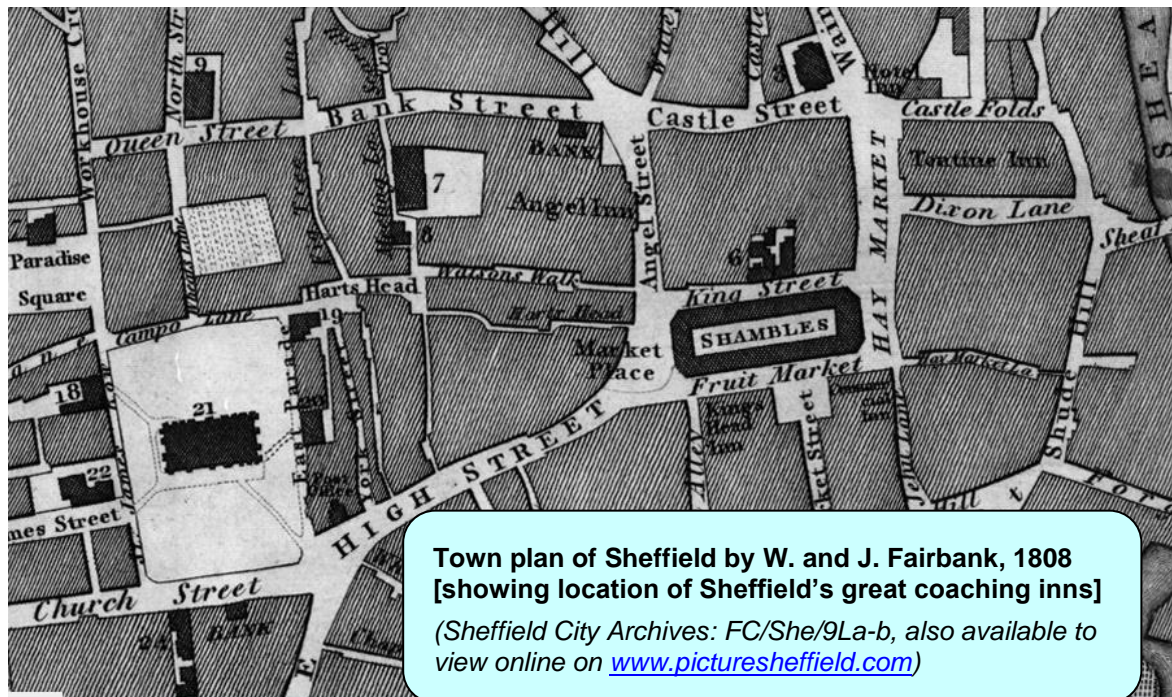

Town plan of Sheffield by W. and J. Fairbank, 1808
[showing location of Sheffield's great coaching inns]
 (Sheffield City Archives: FC/She/9La-b, also available to view online on www.picturesheffield.com)

One unusual printed historical map in our collections - the **'Drink Map' of the Town of Sheffield, 1884** (Sheffield Local Studies Library: S 20 L, also available to view on www.picturesheffield.com refs. y09165 and y09166) - neatly illustrates the sheer number of public houses and licensed premises operating in Sheffield in the latter part of the 19th-century. The Drink Map (extracts of which feature below) was drawn up by the Sheffield Temperance Association in a bid to highlight the apparent excess of public houses, beer shops and other licensed premises in the town and argue for a reduction in their numbers. For details of further sources we hold relating to the Sheffield temperance movement, please see our separate [Temperance Movement Research Guide](#).

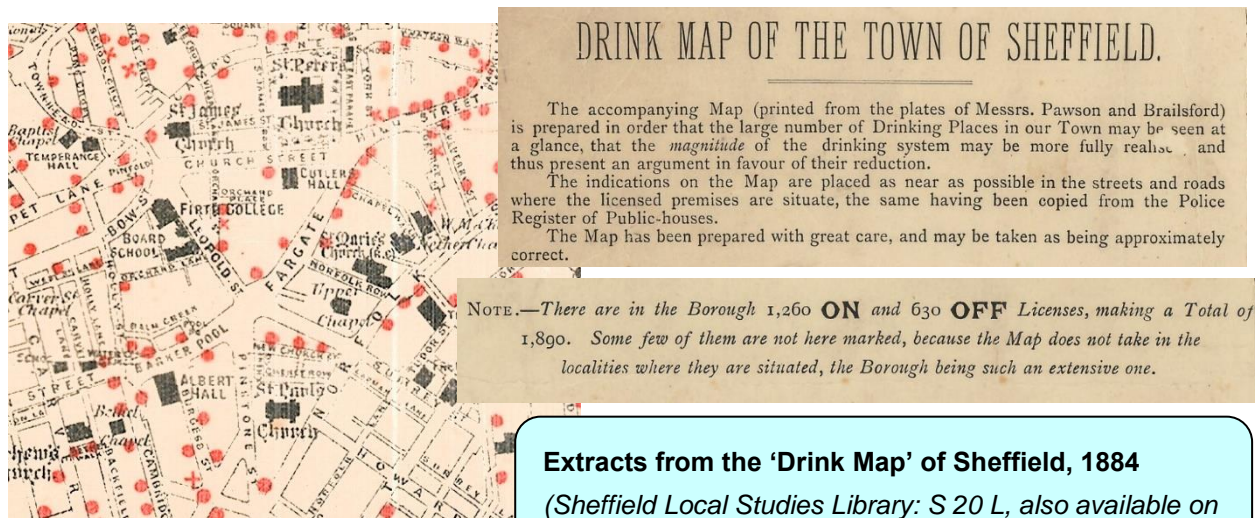

DRINK MAP OF THE TOWN OF SHEFFIELD.

The accompanying Map (printed from the plates of Messrs. Pawson and Brailsford) is prepared in order that the large number of Drinking Places in our Town may be seen at a glance, that the magnitude of the drinking system may be more fully realised, and thus present an argument in favour of their reduction.

The indications on the Map are placed as near as possible in the streets and roads where the licensed premises are situate, the same having been copied from the Police Register of Public-houses.

The Map has been prepared with great care, and may be taken as being approximately correct.

NOTE.—There are in the Borough 1,260 **ON** and 630 **OFF** Licenses, making a Total of 1,890. Some few of them are not here marked, because the Map does not take in the localities where they are situated, the Borough being such an extensive one.

Extracts from the 'Drink Map' of Sheffield, 1884
 (Sheffield Local Studies Library: S 20 L, also available on www.picturesheffield.com, y09165 and u09166)

In terms of identifying *earlier hand-drawn* maps which predate the earliest OS maps, and which can include reference to older Sheffield pubs, the main collection we hold is the **Fairbank Collection (Sheffield City Archives: FC)** which are the records of four generations of the Fairbank Family of Sheffield, surveyors, who surveyed Sheffield and the surrounding area extensively, from 1736 through to 1848. A keyword search of the City Archives' [online catalogue](#), searching under the reference number *FC**, may reveal relevant maps and plans from the Fairbank Collection, relating to historic pubs, for example:

- Plan of Angel Inn premises, Angel Street, Sheffield, measured for sale, [1814] (*Sheffield City Archives: FC/P/SheS/35L*)
- Plan of premises belonging to Thomas Rawson & Co., The Cock Inn, Oughtibridge, 1832 (*Sheffield City Archives: FC/P/Ecc/126S*)
- Plan showing the King's Head Inn, and property opposite, on Change Alley, Sheffield, [1804] (*Sheffield City Archives: FC/P/SheS/258S*)
- Plan of the Rose and Crown, Pond Street, measured for Rawson & Co, [1832] (*Sheffield City Archives: FC/P/SheS/921S*)

Licensing Records

From the second half of the 19th-century, the responsibility for licensing matters and for granting, renewing or refusing licences to individual licensed premises in Sheffield, fell on the Sheffield Magistrates Court Licensing Committee. There are various licensing records within our **Sheffield Magistrates Court Collection (Sheffield City Archives: MC)** including the following items which contain a wealth of information on local pubs:

- Sheffield Division register of beerhouse keepers, c. 1870 - c. 1935 (*Sheffield City Archives: MC/7/1 Use microfilm A174*)
- Sheffield Division register of licensed victuallers, c. 1870 - c. 1935 (*Sheffield City Archives: MC/7/2 Use microfilm A174 and A175*)

Both the above registers include entries for hundreds of individual Sheffield pubs which include the following information: *name of the licence holder; the situation and sign of the 'beerhouse'; the owner's name; convictions on the beerhouse; dates of transfer of the licence, occasional floor plans of the house (dating from the early 1900s); and general remarks*. Both registers are indexed with the indexes (arranged by name of pub) searchable on our web-page: www.sheffield.gov.uk/home/libraries-archives/access-archives-local-studies-library/collections/magistrates-court-records.html. Such indexes will reference the page number in the original register detailing the entry for a particular pub and will also indicate whether the register entry includes a floor plan for the premises, such as the example, below, for the Ball Inn, Crookes.

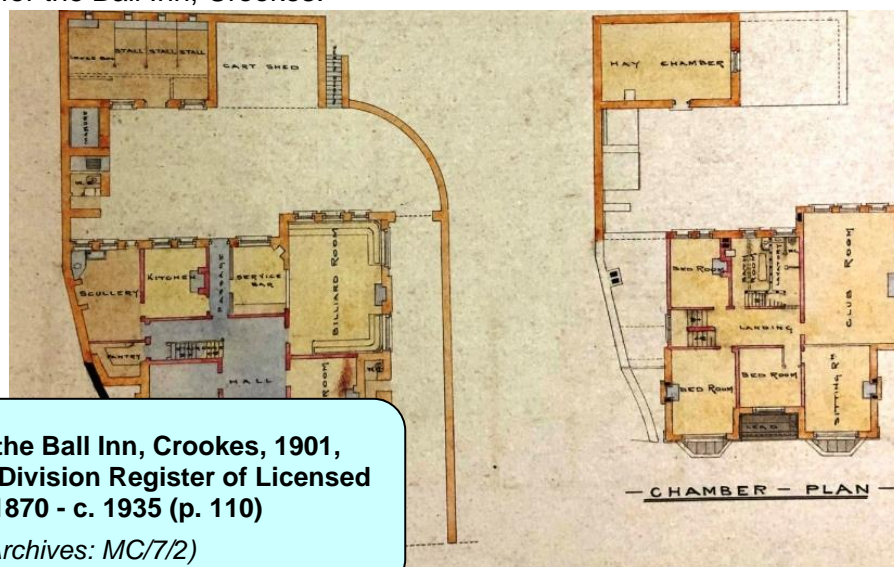

Floor plans of the Ball Inn, Crookes, 1901, from Sheffield Division Register of Licensed Victuallers, c. 1870 - c. 1935 (p. 110)
(*Sheffield City Archives: MC/7/2*)

In terms of *later* licensing registers, there are also the following items in our Sheffield Magistrates Court collection, which generally include the following details: *name, sign and situation of premises, description of licence, dates of transfer and renewal of licence, owner of premises, name of holder of licence, record of convictions* (note: these later registers do not include any floor plans):

- City of Sheffield register of licences: publicans, 1904 - 1953 (indexed by street) (*Sheffield City Archives: MC/20/1/1*)
- City of Sheffield register of licences: publicans, 1954 - 1968 (indexed by name of pub) (*Sheffield City Archives: MC/20/1/2*)
[Note: this register details licence renewals and transfers between 1954 -1968, but includes occasional retrospective details of licensing for individual premises dating back to c. 1906]

It is important to note that pubs in outlying districts of Sheffield, which formerly fell within the West Riding of Yorkshire (and outside the city of Sheffield's boundaries) such as *Bradfield, Ecclesfield, Stannington, Stocksbridge, Chapeltown, Grenoside, Wisewood, Handsworth, Woodhouse*, etc., will not be recorded in the above-mentioned 'Sheffield' division licensing registers. Instead, such pubs should be found in a *separate* series of Sheffield Magistrates Court registers as they fell within a separate **Upper Strafforth and Tickhill Division**, for which we hold registers as follows:

- Upper Strafforth and Tickhill Division register of licences, Aug 1872 - Sep 1881 (*Sheffield City Archives: MC/6/1*)
- Upper Strafforth and Tickhill Division register of licences, Sep 1882 - Sep 1891 (*Sheffield City Archives: MC/6/2*)
- Upper Strafforth and Tickhill Division register of licences, Sep 1892 - Sep 1896 (*Sheffield City Archives: MC/6/3*)

The above registers are arranged by township and are indexed by name of owner and license holder. They give: *date of renewal of licence, particulars of licence, name and situation of property, annual value of premises, name and address of owner of premises, name of licence holder, transferee, date of transfer, disqualification of premises and record of any convictions*. There is also a later series of Upper Strafforth and Tickhill Division registers as follows:

- Upper Strafforth and Tickhill Division register of licences: publicans, 1903 - c.1918 (indexed by name of publican) (*Sheffield City Archives: MC/21/1/1*)
- Upper Strafforth and Tickhill Division register of licences: publicans, 1919 - 1965 (indexed by parish/place and then name of licensed premises) (*Sheffield City Archives: MC/21/1/2*)

For any pub which was still open for business in Sheffield in the latter part of the 20th-century, there is a very good chance that a *licensing file* will have survived for it (which will often include plans of the premises relating to proposed alterations submitted to the magistrates court licensing section for approval). Within our Sheffield Magistrates Court Collection, there are licensing files for over 700 separate licensed premises in the following series of records:

- Licensing Files for Individual Pubs, Clubs and On-Licensed Premises, 1888 - 2005 (*Sheffield City Archives: MC/20/5*)

Each licensing file generally comprises loose licensing register sheets for the premises, mostly covering the period c. 1960s - c. 2001, detailing the following information: *sign and address of premises; description of licence; name and address of owner; date of transfer of*

licence; name of holder of licence; details of any licensing conditions, certificates, etc. Such files often include plans of the premises too (relating to proposed alterations, etc.) which, in some cases, date back to the late 19th-century. Each pub and on-licensed premises in Sheffield generally had its own licensing file (and files for those which were still operating towards the end of the 20th-century have mostly survived in our holdings). A keyword search of the City Archives' [online catalogue](#), searching under the reference number MC/20/5*, may well reveal reference to files for specific pubs of interest.



Early plans of pubs from the above series of licensing files can show interesting detail including locations and layouts of dram shops, bottle stores, beer cellars, billiard and bagatelle rooms, smoke rooms, club rooms, tap rooms, privies, coal pits, carriage and coach houses, stables, manure pits, ash pits, hay and pigeon lofts and even pig sties!

Plan showing part of elevation of West Street Hotel, 1930, from Sheffield Magistrates Court licensing file (Sheffield City Archives MC/20/5/183)

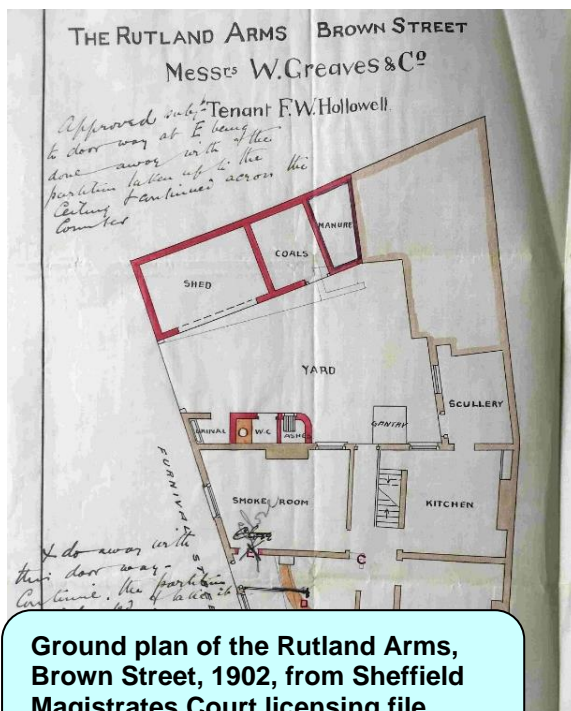

Ground plan of the Rutland Arms, Brown Street, 1902, from Sheffield Magistrates Court licensing file (Sheffield City Archives: MC/20/5/180)

Drawing marked B shows the rooms as now rebuilt.
 As there are some 400 Druids hold their meetings at this house, the old Club room was much too small and inconvenient.
 The proprietors, under these circumstances now ask the Magistrates consent to add to the Club room, the space that was previously a store room

J. P. Earle

Letter from architect J. P. Earle, asking permission for approval of plans to expand the Club Room at the Royal Oak Hotel, Cemetery Road, May 1898, from Sheffield Magistrates Court licensing file (Sheffield City Archives: MC/20/5/111)

Occasionally, the licensing files include letters and papers relating to specific licensing matters such as the example pictured above right - a letter from the architect J. P. Earle requesting that magistrates consent to plans to expand the "Club Room" at the Royal Oak Hotel, Cemetery Road (which later became the Beer Engine), claiming additional space is needed "as there are some 400 Druids" who meet there!

Architectural Plans

The largest single collection of architectural plans of Sheffield pubs we hold is found in the series of licensing files outlined above. However, smaller selections of plans of pubs can be found in the following collections at Sheffield City Archives:

- Sheffield City Council Planning Application Files (including building plans), from c.1864 onwards
(*Sheffield City Archives: CA206*)

A keyword search of the City Archives' [online catalogue](#), searching under the reference number *CA206**, may reveal relevant planning application files (which should include plans relating to proposed alterations of premises, etc.) for example:

- Angel Street Hotel, Angel Street, Sheffield - additions and alterations, 1 Apr 1898 (*Sheffield City Archives: CA206/3496, available on aperture card*)
- Grapes Inn, Cross George Street, Philadelphia, Sheffield - additional club room and billiard room, 7 Jan 1865 (*Sheffield City Archives: CA206/3*)
- King's Arms Hotel, Commercial Street, Sheffield - alterations, etc., late 19th - 20th cent (*Sheffield City Archives: CA206/8441a-b*)

There are also other separate smaller series of planning application files which will include files relating to pubs on the outskirts of Sheffield which formerly fell within the jurisdiction of separate *Rural District Councils*, for example:

- Planning application files inherited from Chesterfield Rural District Council, 1933 - 1967 (*Sheffield City Archives: CA519*) which include files for certain pubs in the Gleadless, Beighton, Mosborough and Hackethorpe districts (a keyword search of the City Archives' [online catalogue](#), searching under the reference number *CA519**, may reveal relevant items)
- Planning application files for Norton Rural District Council, 1885 - 1926 (*Sheffield City Archives: CA208a*) which include files for certain pubs in the Norton, Woodseats, Dore, Totley and Bradway districts (a keyword search of the City Archives' [online catalogue](#), searching under the reference number *CA208a**, may reveal relevant items)

Note: most planning application files are held in offsite storage and up to **two weeks' notice is required before such items can be recalled and made available for consultation.**

- Miscellaneous Architectural Plans Collection, 1747 - c. 1980s
(*Sheffield City Archives: AP*)

A keyword search of the City Archives' [online catalogue](#), searching under the reference number *AP**, may reveal relevant plans of public houses from this architectural plans collection, for example:

- Anvil Inn, Waingate, Sheffield, 1854 (*Sheffield City Archives: AP/1/18, alt. ref. AP/18*)
- Old Barrel Inn, Solley Street, Sheffield, 1899 (*Sheffield City Archives: AP/1/19, alt. ref. AP/19*)
- Old Queen's Head, Pond Street, Sheffield, 1948 (*Sheffield City Archives: AP/1/37, alt. ref. AP/37*)

Photographs/Images

Over 100,000 images from the Sheffield Local Studies Library and City Archives collections are available to search online at www.picturesheffield.com. These include hundreds of images relating to individual public houses and beerhouses in Sheffield, many of which have long since ceased to exist.

Earl Grey Public House, 97 Ecclesall Road, Sheffield [closed 1983], pictured early 1900s

(Sheffield Local Studies Library Picture Sheffield: s07013)



Newspaper Articles

Articles relating to Sheffield pubs will appear in local newspapers. Sheffield newspapers are available at the Local Studies Library dating from 1787 through to the present day. It is now possible to access some historical Sheffield newspapers online via the British Newspaper Archive website www.britishnewspaperarchive.co.uk (digitized local titles available on this site include the *Sheffield Register* covering 1787 - 1794, the *Sheffield Iris* covering 1835 - 1843, the *Sheffield Independent* covering 1819 - 1938 and the *Sheffield Daily Telegraph* covering 1855 - 1950 although coverage can be patchy, particularly towards the mid-20th century). The indexes to the British Newspaper Archive can be searched online for free (via 'keyword'). Although you have to have a subscription to view any relevant articles, Sheffield Local Studies Library can provide free access to the Sheffield newspapers on microfilm and the Local Studies Library and the City Archives (and any Sheffield branch library) are able to provide free full online access to the British Newspaper Archive via the family history website www.findpast.co.uk (to which we have a subscription).



The Local Studies Library local newspaper cuttings collection may also include articles on Sheffield pubs

(Sheffield Local Studies Library: microfiche)

Newspaper announcement of new coach service to York from the King's Head Inn, Change Alley, Sheffield, 15 Jul 1820

(Sheffield Local Studies Library: Sheffield Independent, 15 Jul 1820 p.3)

Newspaper reports of coroner's inquests, held at the Bull and Mouth Inn, Waingate, Sheffield, 24 Nov 1821

(*Sheffield Local Studies Library: Sheffield Independent, 24 Nov 1821 p.3*)

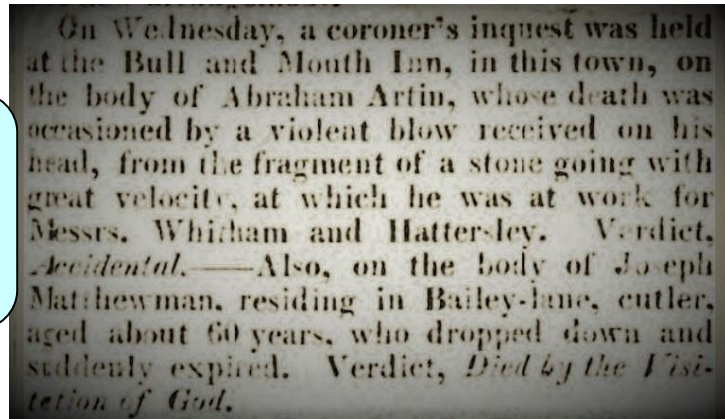

On Wednesday, a coroner's inquest was held at the Bull and Mouth Inn, in this town, on the body of Abraham Artin, whose death was occasioned by a violent blow received on his head, from the fragment of a stone going with great velocity, at which he was at work for Messrs. Whitham and Hattersley. Verdict, *Accidental*.—Also, on the body of Joseph Matthewman, residing in Bailey-lane, cutler, aged about 60 years, who dropped down and suddenly expired. Verdict, *Died by the Visitation of God*.

The *Sheffield Star* and *Sheffield Telegraph* have some of their articles from recent years available online at: www.thestar.co.uk and www.sheffieldtelegraph.co.uk. In addition, the *Sheffield Star* (2011 onwards) is available for free via Sheffield Libraries: <https://search.proquest.com/europeannews/>.

Sale Plans and Particulars

The Local Studies Library holds a large collection of sale plans and particulars, dating from the late 18th century, which include those relating to Sheffield pubs and can provide a useful snapshot of the extent, fixtures and fittings, etc., of a particular premises when it was put up for sale. A keyword search of the Local Studies Library's online catalogue (available on the [Sheffield Library catalogue](#), choosing 'Local Studies Library' from the drop-down menu), may reveal relevant items, for example:

- Particulars and plan of leasehold public house known as the Lincoln Castle Inn, also shops, workshops and dwelling houses adjoining, situate in Brocco, Edward and Allen Streets, Sheffield, 1883 (*Sheffield Local Studies Library: Sale Plan 30 Oct 1883*)
- Particulars, plan and conditions of sale of the Angel Inn with the saleshop adjoining and workshops and premises at the back on Angel Street, Sheffield, 1896, (*Sheffield Local Studies Library: Sale Plan 1 Dec 1896*)
- Particulars and plan of valuable freehold fully-licensed public house and dwelling houses, 1897, known as the Hallamshire Hotel, Lydgate Lane, Crookes, Sheffield (*Sheffield Local Studies Library: Sale Plan 15 Jun 1897*)
- Particulars and plan of old-accustomed fully-licensed freehold public-house known as the Stag Hotel, Sharrow Head, Sheffield with extensive stabling, carriage houses etc and of freehold plot of land adjoining, 1897 (*Sheffield Local Studies Library: Sale Plan 6 Jul 1897*)

Deeds

As well as detailing transfers of ownership and occupancy, deeds can reveal a wealth of information about a building's history. Deeds for only a proportion of Sheffield pubs have found their way into the holdings of the City Archives. The following collections we hold however do include deeds relating to various Sheffield pubs:

- Deeds relating to Sheffield City Council owned land formerly housed at the Council's Deed Registry, 1571 - 1978 (*Sheffield City Archives: CA778*)

The above collection includes deeds relating to dozens of historic pubs in Sheffield. A keyword search of the City Archives' [online catalogue](#), searching under the reference number CA778*, may reveal relevant items, for example:

- Angel Inn, Angel Street, 1746 - 1925 (CA778/7344)
- Crown Inn (and other property), Duke Street, Park, 1790 - 1968 (CA778/14085)
- George and Dragon Hotel, Bank Street, 1791 - 1919 (CA778/80001)
- Pheasant Inn and premises in Broad Street, Park, Sheffield, 1792 - 1904 (CA778/2425)

Note: deeds from the above collection are held in offsite storage and up to two weeks' notice is required before such items can be recalled and made available for consultation.

- Rodgers and Howe, Solicitors, Sheffield: uncatalogued series of title deeds relating to public house/hotels in South Yorkshire (formerly owned by the brewery companies Duncan Gilmour & Co. Ltd, W. Greaves & Co. Ltd, Messrs Thomas Rawson & Company, etc.), 18th-20th cent
(Sheffield City Archives: RH Acc. 1998/118 add 1)

The above series includes parcels of deeds for the following Sheffield pubs: Abbey Hotel, Norton Woodseats; Bell Hotel, Fitzalan Square; Birley Hotel, corner of Birley Street and Woodside Lane; Black Bull, Ecclesfield; British Oak, Carbrook Street, Attercliffe; Broomhill Tavern, Glossop Road and Peel Street; Carwood Hotel, Carlisle Street East and Carwood Lane; Chantrey Arms, Woodseats; Coach and Horses, Attercliffe; Cossack Inn, Howard Street; Crown, Scotland Street; Crown, Walkley Road; Dog and Partridge, Trippet Lane; Fox and Duck, Pitsmoor Road and Pye Bank Road; Green Dragon, Attercliffe; Hadfield Hotel, Barber Road; High Greave Inn, Ecclesfield; Holly Bush or Hollin Tavern, Hollins Lane, Rivelin; Howard Hotel, Howard Street and Pond Street; Junction Hotel, Furnace Lane; Jury Tavern, Handsworth Woodhouse; Leg of Mutton Inn, Grenoside; Montgomery Hotel, St Mary's Road; New Inn, Ecclesall Road; New Inn, Gleadless; New Inn, Norton Backmoor; Old Cross Daggers, Handsworth Woodhouse; Old Light Horseman, Penistone Road; Porter Cottage, Sharrow Vale; Princess Royal, Woodhouse Mill; Red Lion, Duke Street; Red Lion, Gleadless; Red Lion, Heeley; Rising Sun, Jenkin Road, Brightside; Rose and Crown Inn, Main Road, Darnall; Royal Hotel, Handsworth Woodhouse; Shakespeare Inn, Well Road and Gleadless Road; Slate Inn, Wicker; Sportsman Inn, Wilkinson Road, Norton; Station Inn, Station Road, Oughtibridge; Star and Garter, Weston Street; Waggon and Horses, Chapelton; Washington Arms Hotel, Washington Road; Waterman's Rest, corner of Effingham Street and Sussex Street; West End Tavern, Clarkson Street; White Hart, Greenhill; Woodseats Hotel, Norton Woodseats; Yew Tree, Loxley End, Loxley Lane; Yorkshireman's Arms, Burgess Street.

If deeds for a particular Sheffield pub cannot be located in the holdings of the City Archives (and if the premises was built prior to 1970) it is possible that [West Yorkshire Archives Service, Wakefield](#) (email: wakefield@wyjs.org.uk) might be able to assist. West Yorkshire Archives Service holds records of the *West Riding Registry of Deeds* which was established in 1704 to register deeds for freehold property in the West Riding of Yorkshire (which included Sheffield and South Yorkshire). 'Memorial copies' of over seven million deeds covering the years 1704 to September 1970 were lodged with the West Riding of Deeds up until its closure in 1970.

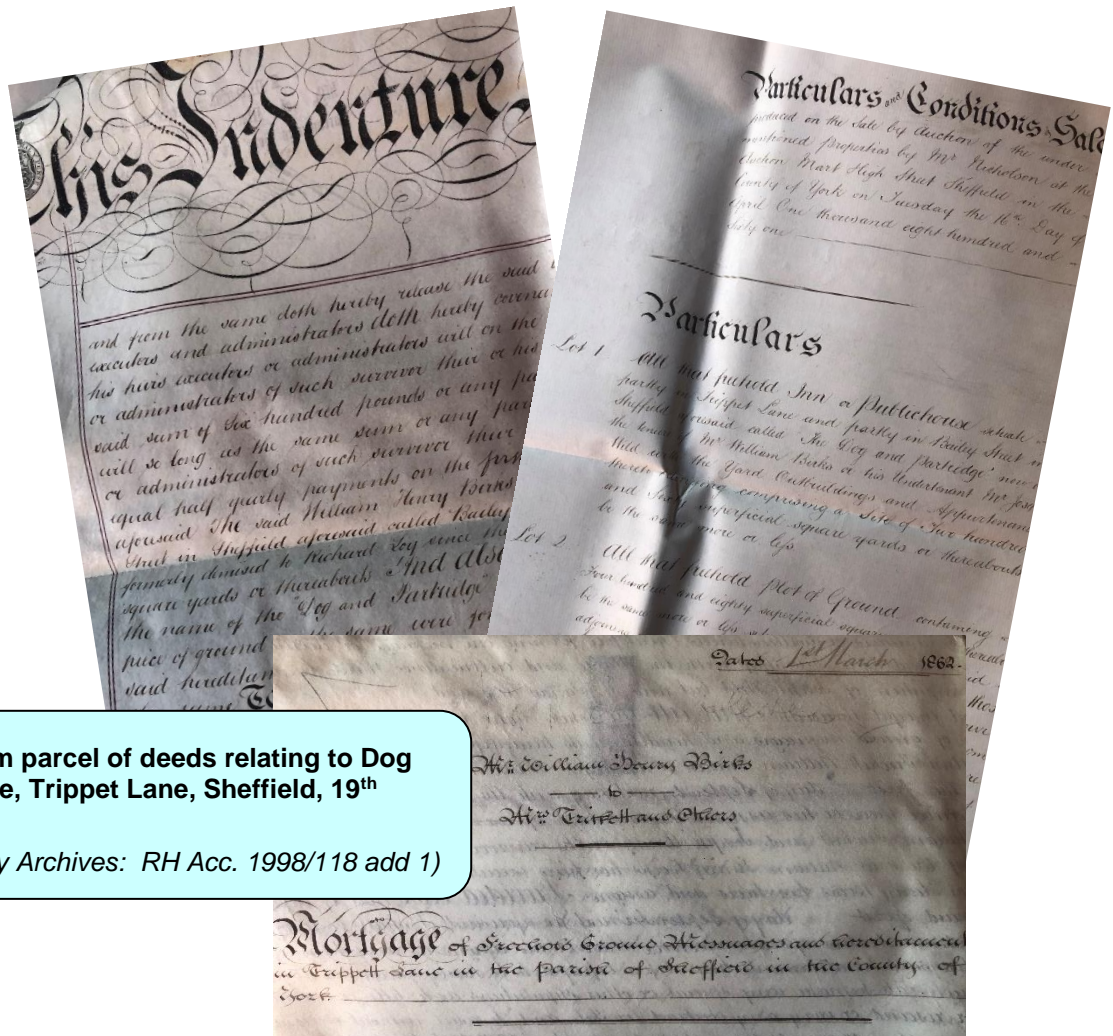

Extracts from parcel of deeds relating to Dog and Partridge, Trippet Lane, Sheffield, 19th century

(Sheffield City Archives: RH Acc. 1998/118 add 1)

Landed Estate Records

The major landowners in Sheffield since 1616, were the Dukes of Norfolk who inherited their Sheffield estates from the Earls of Shrewsbury. The City Archives is home to a large collection of records relating to the Duke of Norfolk's Sheffield estates including surveys, maps, deeds, rentals and accounts. This collection is known as the **Arundel Castle Muniments Collection (Sheffield City Archives: ACM)** named after the Duke of Norfolk's historic family seat of Arundel Castle in Sussex. The collection (the catalogue of which is searchable on the City Archives' [online catalogue](#), under the reference number ACM*) includes estate rentals dating back to the 16th-century which may include references to early 'brew houses' and later beerhouses/alehouses, inns, taverns and public houses in Sheffield. The collection also includes several items relating to one of Sheffield's most prominent coaching inns, the Tontine Inn, Haymarket (which was acquired by the Duke Norfolk in 1850 and subsequently demolished to make way for the new Norfolk markets) as follows:

- Plans, sections and elevations for the proposed Tontine Inn, c. 1780 - 1785 (Sheffield City Archives: ACM/MAPS/1/35, alt. ref. ACM/MAPS/EBu/263)
- Elevations and plans (ground and first floors) for the Tontine Inn, c. 1780 - 1783 (Sheffield City Archives: ACM/MAPS/1/34, alt. ref. ACM/MAPS/SheS/1429bL)
- Bill for furnishing Lord Surrey's room at the Tontine Inn, 1786 (Sheffield City Archives: ACM/17/7/4, alt. ref. ACM/S/476/4)
- Minutes of evidence, case award and bill for expenses for arbitration case between the Duke of Norfolk and the proprietors of the Tontine Inn, 1849 (Sheffield City Archives: ACM/13/7/1, alt. ref. ACM/S/352)

- Plan of the Tontine Inn and other property bounded by the Haymarket, Dixon Lane, Exchange Street and Castle Folds, c. 1850 [pre-1851] (*Sheffield City Archives: ACM/MAPS/1/15f, alt. ref. ACM/MAPS/SheS/1945L*)

Brewery Company Records

The City Archives holds several large collections of records of Sheffield-based brewery companies which formerly owned many of the pubs in Sheffield. These include the following:

- Duncan Gilmour and Company, Lady's Bridge Brewery, Bridge Street, Sheffield, 1854 - 1971 (*Sheffield City Archives: DG*)
- S. H. Ward and Company Limited, Sheaf Brewery, Ecclesall Road, Sheffield, 1836 – 1996 (*Sheffield City Archives: SHW*)
- Tennant Brothers Ltd, Exchange Brewery, Bridge Street, Sheffield (and associated breweries), 1789 - 1995 (*Sheffield City Archives: MD7518*)

Further details about the contents of these brewery company collections, which for each include minutes, accounts, correspondence, production and sales records, property records, etc., can be found on the City Archives' [online catalogue](#), searching under the respective reference number for each collection).

Rating and Valuation Records

The City Archives holds large collections of hundreds of Sheffield **Rate Books** and **Valuation Lists** which can include brief information on Sheffield's pubs in the past. Such rate books and valuation lists are generally arranged by township (and later ward) and then by street. The early rate books from 1755 only include minimal information - name of occupiers of houses on a particular street and rate collected. However, by 1821 (along with separate valuation lists which include the rateable value of each property) rate books can include a brief description of each property (e. g, 'brew house', malt house', etc). For further details of the Sheffield Rate Books and Valuation Lists available, see the City Archives' [online catalogue](#), searching under the respective reference numbers for each collection:

- *Rate Books, 1755 - c. 1940 (Sheffield City Archives: CA-RB)*
- *Valuation Lists, 1817 - c. 1940 (Sheffield City Archives: CA-VAL)*

Census Returns

Although Sheffield street/trade directories (mentioned above) should list former landlords/landladies of a pub for a given year, for details of other family members, and any domestic servants/staff, living at the premises between the years 1841 - 1911, census records can be a useful resource. Census records (listing every resident by household and including names, relationships, occupations, ages and birth places) taken every 10 years from 1841 through to 1911, are available free at the City Archives and the Local Studies Library (and at any Sheffield library) via www.findmypast.co.uk.

Other Miscellaneous Contemporary Documents

The collections listed above are the main sources available at the City Archives and Local Studies for researching the history of Sheffield's pubs. A search of our catalogues may reveal additional references to further individual items of potential interest amongst other collections we hold, for example:

Sheffield Town Trustee accounts [includes various references to expenditure in connection with early inns / public houses], 1566 - 1873
(*Sheffield City Archives: TT/4/1/1-10*, also transcribed in J. D. Leader, *The Records of the Burgery of Sheffield - Sheffield Archives: TT Print Source* or *Sheffield Local Studies Library: 942.74 S*)

Proposals for building a large and commodious inn and tavern in Sheffield [the Tontine Inn, Haymarket], including list of almost 50 subscribers and nominees, Sep 1785
(*Sheffield City Archives: JC/29/32, alt. ref. JC/1556*)

Proposals for construction of the Tontine Inn, Haymarket, 1785, with statement of accounts, 1791
(*Sheffield City Archives: Wil D/7/1/5, alt. ref. Wil D/420a*)

Tontine Inn accounts, 1793 and 1802
(*Sheffield City Archives: MD5863/1*)

Tontine Inn bills for alcohol, fruit, tea, waiters, maids, etc., 1815 - 1816, 1838
(*Sheffield City Archives: JC/22/228, alt. ref. JC/1648*)

Books and Publications

There are dozens of publications and secondary sources available relating to Sheffield's pub history at Sheffield Local Studies Library and the City Archives, including the following general titles:

Banks, W. A., *A Pub on Every Corner: A Directory of Local Hotels, Inns and Taverns* (1988)
(*Sheffield Local Studies Library: 728.5 SQ*)

Davey, Roy, *Pubs and People around Sheffield* (Richardson, 1983)
(*Sheffield Local Studies Library: 728.5 S*)

Firth, Mike (ed.), 'My Kind of Town: Nostalgic Reflections of Bygone Sheffield' magazine issues [include regular features offering reflections of Sheffield's pubs in times past, for example, 'Bygone Boozers: when the pumps ran dry' in issue 36), (c. 2011 onwards)
(*Sheffield Local Studies Library: 942.74 SQ*)

Gamston, David, *Yorkshire's Real Heritage Pubs: pub interiors of special historic interest in Yorkshire and Humber* (CAMRA 2016)
(*Sheffield Local Studies Library: 647.95 S*)

Lamb, Douglas, *A Pub on Every Corner* (Hallamshire Press, 1996) [includes listings of some 1,500 pubs known to have existed in Sheffield's history, with locations marked on maps, as well as historical information on pubs and breweries, etc., in Sheffield]
(*Sheffield Local Studies Library: 728.5 S; Sheffield City Archives: LAM/LOCAL*)

Lamb, Douglas, *Last Orders: Sheffield's Pubs* (Pickard, 2000)
(*Sheffield Local Studies Library: 728.5 LS*)

Leader, Robert Eadon, *Sheffield in the Eighteenth Century*, 2nd ed. (Sir W. C. Leng & Co. Ltd, 1905) [includes historical details about various coaching inns and other public houses in Sheffield - see index for references to specific premises]
(*Sheffield Local Studies Library: 942.74 SST; Sheffield City Archives: LEA/LOCAL*)

Leader, Robert Eadon, *Reminiscences of Old Sheffield, its Streets and its People*, 2nd ed. (Leader and Sons, 1876) [includes historical details about various public houses in Sheffield - see index for references to specific premises]
(*Sheffield Local Studies Library*: 942.74 S; *Sheffield City Archives*: LEA/LOCAL)

Liversidge, Michael, *The Definitive A to Z Listing of Sheffield Public Houses* (Pickards Colour Publishing, 1999)
(*Sheffield Local Studies Library*, 647.954282 Q)

Liversidge, Michael, *Closing times. Vols. 1 and 2, as they were...and what's there now* (Pickards, 2017)
(*Sheffield Local Studies Library*: 647.9542 SQ)

Liversidge, Michael, *Time Gentlemen Please: The Demise of the Sheffield Public House* (Youbooks.com, 2008)
(*Sheffield Local Studies Library*: 728.5 SF)

Manton, Dafydd, *Ale and Arty in Sheffield: The Disappearing Art of Pub Signs* (Arc, 2008)
(*Sheffield Local Studies Library*: 725.72)

Parry, David, *Bygone Breweries of Sheffield: A Summary of the Brewing Trade in the City 100 years ago* (Richardson, 1981)
(*Sheffield Local Studies Library*: 663.3 SQ; *Sheffield City Archives*: PAR/BUS)

Pickersgill, Dave, *Sheffield's Real Heritage Pubs - Pub Interiors of Historic Interest*, 2nd Ed. (Sheffield CAMRA, 2018)
(*Sheffield Local Studies Library*: 647.9542 S)

Stones, William (Ltd), *Photograph Album of William Stones Ltd Public Houses in South Yorkshire (including former Mappins Brewery properties)* (c. 1900) [note: images of the Sheffield pubs from this volume are available to view on www.picturesheffield.com]
(*Sheffield Local Studies Library*: 728.5 SSTF)

Rotherham, Ian D., *Sheffield Pubs* (Amberley, 2016)
(*Sheffield Local Studies Library*: 728.5 SQ)

Sheffield CAMRA, 'Beer Matters' magazine [includes regular features on Sheffield's pub heritage], from 1999 onwards
(*Sheffield Local Studies Library*: 663.4 SQ)

Stringfellow, Andrew, *Sheffield Pubs and Beerhouses Maps 1879-1959* (2014) [photocopies of Sheffield maps annotated with pub locations]
(*Sheffield Local Studies Library*: 728.5 Q)

Tatton, Henry, *Old Sheffield: Sketches and Notes*, vols. 1-3 (c. 1920s?) [includes various sketches and notes relating to Sheffield's historic pubs, see, for example, 'Details of the sale of the Angel Inn in 1810' in volume 2 p.159 and 'Short Details of Old Sheffield Public Houses' in volume 3 p.554]
(*Sheffield Local Studies Library*: 942.74 SQ)

Tuffrey, Peter, *Sheffield Pubs: Landlords and Landladies* (Fonthill Media, 2012)
(*Sheffield Local Studies Library*: 728.5 S)

Turley J. P., *Sheffield's Yesterday: Places, People and Pubs* (1993)
(*Sheffield Local Studies Library: 942.821*)

Turley, J. P., *101 Pictures of Lost Sheffield pubs* (ALD Design, 1998)
(*Sheffield Local Studies Library: 728.5 S*)

Turley J. P., *Pictures of Lost Sheffield Pubs* (Harry Good, 1991)
(*Sheffield Local Studies Library: 728.5 S*)

Library and Archive collections held elsewhere

For historical information relating to pubs situated in suburbs of Sheffield which were formerly located in Derbyshire (e.g. Beighton, Norton, Woodseats, Meersbrook, Greenhill, Bradway, Dore, Totley, etc.) some relevant material may be held at [Derbyshire Record Office](#).

For historical information relating to pubs situated in suburbs of Sheffield which were formerly located in the West Riding of Yorkshire (e.g. Bolsterstone, Bradfield, Chapelton, Ecclesfield, Stannington, Loxley, Wadsley, Oughtibridge, Shiregreen, Handsworth, Grenoside, etc.) some relevant material may be held at [West Yorkshire Archive Service](#).

[West Yorkshire Archive Service](#) also holds historic records of the West Riding Quarter Sessions Court dating back to the 1600s which may include information relating to Sheffield's early public houses.

Sheffield City Archives and Local Studies Library Facilities

Sheffield City Archives and Local Studies services collect and preserve original records and printed material relating to Sheffield and the surrounding area. The information dates from the 12th century to the present and relates to Sheffield, South Yorkshire and north Derbyshire.

Included are extensive collections of books • pamphlets • photographs • church registers • newspapers • census records • minutes • diaries • films • maps • deeds • records from schools • hospitals • businesses and charities • family estates • personal papers etc.

Our facilities include:

- Study areas
- expert staff on hand to help you make the most of your visit
- a library of reference books
- photocopying and photography services
- free Wi-Fi
- Free access to Ancestry and FindMyPast
- microform machines and printers
- catalogues and indexes
- CD-Rom library
- On-line image library

Adding to our collections

Sheffield Libraries and Archives seeks to preserve information about events in our city's history. If you have photographs or personal papers that may be worth preserving, please consider safeguarding them for current and future generations by placing them in the care of Sheffield Libraries and Archives. It is only through the generosity of individuals and organisations that we are able to have a complete record of important events in the history of Sheffield and the nation. We are interested in photographs, flyers and posters, minutes of meetings etc. For advice on record keeping and the facilities we offer please email us (archives@sheffield.gov.uk or telephone 0114 203 9395).

Contact Details

Sheffield Local Studies Library

1st floor
Central Library
Surrey Street
Sheffield
S1 4SP

Tel: 0114 273 4753

Email: archives@sheffield.gov.uk

Sheffield City Archives

52 Shoreham Street
Sheffield
S1 1XZ

Tel: 0114 203 9395

Email: archives@sheffield.gov.uk

Website: www.sheffield.gov.uk/archives

Search our catalogues:

(not all of the collections are fully catalogued so if you can't find what you are looking for please contact us for further advice)

Local Studies Library catalogue: https://library.sheffield.gov.uk/client/en_GB/default

City Archives catalogue: www.calmview.eu/SheffieldArchives/CalmView/

For 100,000+ images of Sheffield visit www.picturesheffield.com

Follow us on Twitter www.twitter.com/sheffarchives

Follow us on Facebook www.facebook.com/shefflibraries

Watch our YouTube videos www.youtube.com/user/SheffieldArchives1

Read our blogs <http://shefflibraries.blogspot.co.uk/>

View some of our photographs on Flickr www.flickr.com/photos/shefflibraries