



GLEADLESS VALLEY MASTERPLAN

FINAL REPORT 2022



CONTENTS

INTRODUCTION

- Baseline Report Summary

CHAPTER 1 – COMMUNITY ENGAGEMENT AND DESIGN PROCESS

- Resident Survey and Community Events (2017)
- ‘Design for Change’ process
- Option Exhibitions and Consultation
- Employment and Skills Consultation
- Council Consultation (2019 – 2021)
- Design Development (2019 – 2021)
- Public Consultation (2022)

CHAPTER 2 – FINAL MASTERPLAN

- Vision and aims
- Housing
- Shared and Green Spaces
- Services and Facilities
- Employment and Skills

CHAPTER 3 – DELIVERY AND FUNDING

- Delivery Structures and Resident Involvement
- Delivery Plan
- Funding and Timescales

CHAPTER 4 – CONCLUSIONS AND NEXT STEPS

- Conclusions and Next Steps
- Future Studies

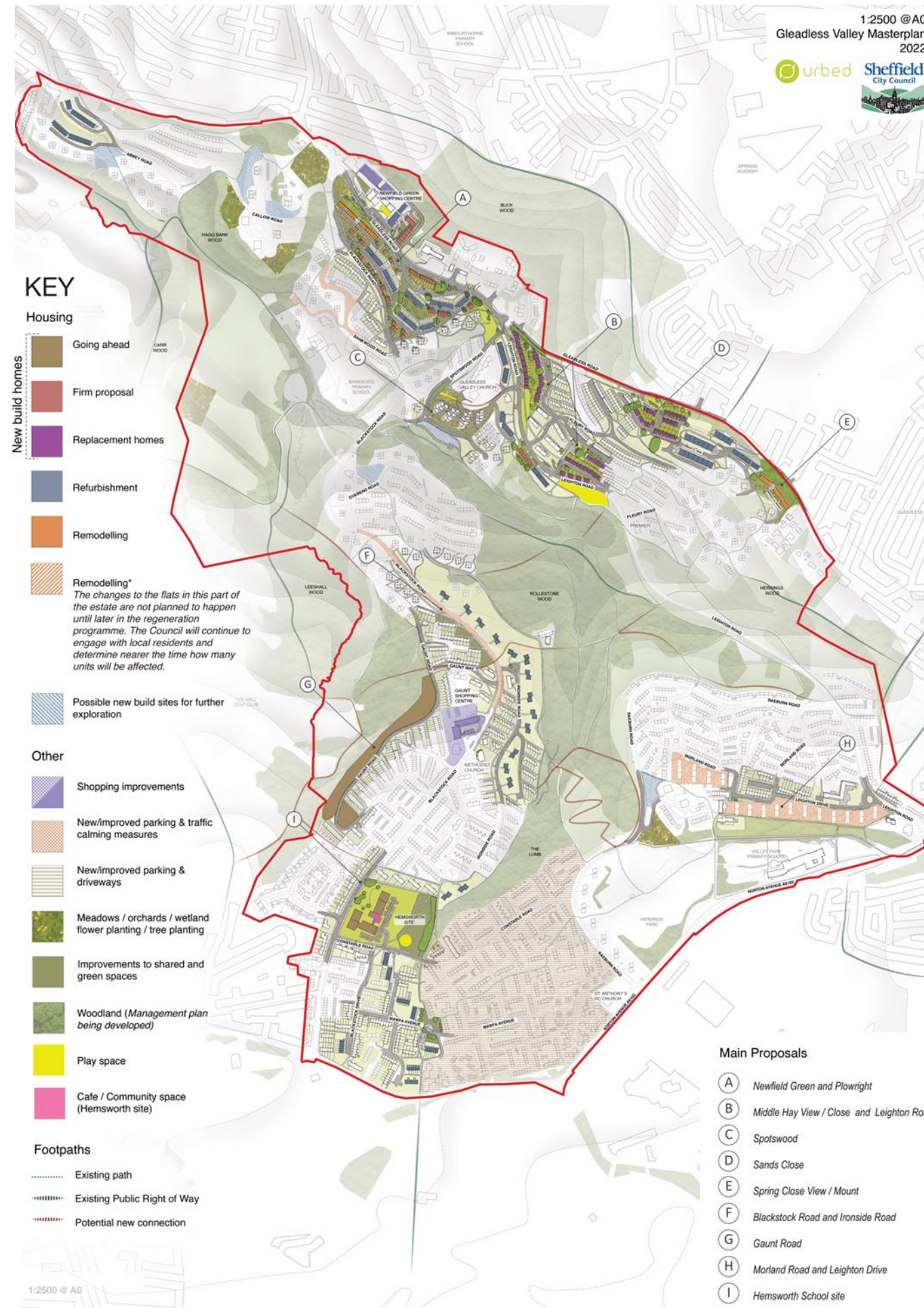

Gleadless Valley Masterplan
September 2022

This document has been produced
by URBED on behalf of Sheffield
City Council

Expanded versions of initial
reports (such as the full Baseline
Report, produced in 2018) are
available as Appendices to this
Final Report.

INTRODUCTION

URBED and ADE Regeneration were engaged in 2018 by Sheffield City Council (SCC) to develop a long-term 'masterplan' for Gleadless Valley, in conjunction with partners and the local community.

- URBED are an urban design company with a focus on environmental sustainability and community-led design.
- ADE Regeneration help to turn ideas into deliverable projects using economics and funding expertise.
- Architects BDP became involved in 2019 to test and develop plans for specific sites in more detail.

This document forms the final masterplan for the Valley. Its purpose is to ensure that co-ordinated, effective, and sustainable regeneration proposals are delivered in line with the vision for the area. It will also support the Council and its partners to bid for future funding opportunities to help deliver the masterplan goals.

Gleadless Valley

Gleadless Valley is a vast social housing estate, which was built in the south of Sheffield in the late 1950s. The innovative and experimental design was celebrated at the time of construction. More recently, however, the reputation and built fabric of Gleadless Valley has deteriorated and some of the Valley's outdated housing stock requires upgrading.

This presents a great opportunity to consider a wider holistic strategy for Gleadless Valley under the key themes of:

- Housing
- Shared and Green Spaces
- Services and Facilities
- Employment and Skills

Each of these themes have their own strategy and principles document which can be found in appendix 2.

Over the past few years, the team at SCC and URBED have carried out a series of consultation events with residents and community groups to identify opportunities and priorities for improvement. This process accompanied a study of the existing area context: including local population characteristics, transport networks, crime statistics and access to local green spaces. The projects in this document have been developed based on consultation with residents and community groups.

A VISION FOR CHANGE

Sheffield City Council's vision for Gleadless Valley is for it to continue to be a great place to live, grow up and grow older, with fantastic green spaces and good quality housing. It will have a strong sense of community spirit and allow its residents to thrive.

THE GOALS OF THE PLAN ARE TO:

- Put residents at the heart of this masterplan
- Preserve and enhance the local character, heritage and wildlife
- Promote better use and care of the valleys green and open spaces
- Deliver services and facilities that meet the needs of the valley and improve play and recreation provision
- Work with the community to improve the health and wellbeing of GV residents
- Grow skills and employment opportunities for all
- Increase the choice, mix and quality of homes
- Improve routes throughout the valley linking public transport, services, homes and green spaces
- Support climate change resilience through delivery of the masterplan projects



Housing



Shared and Green Spaces



Services and Facilities



Employment and Skills

INTRODUCTION

Baseline Report Summary

Gleadless Valley is a distinctive housing estate which was built in south-east Sheffield in the 1950s. The estate comprises of roughly 4,600 homes, of which over 50% are council owned properties. Much of Gleadless Valley remains unchanged since its original construction, and several property types have become outdated and unpopular. The estate was landscaped so as to retain a park-like quality, with housing spreading between the mature woodland. The steep terrain presents many development challenges, but also affords residents with excellent views across the city.

There are several local neighbourhoods within the wider Valley boundary, and these eleven distinctive areas vary significantly in terms of housing stock, facilities provision, and the residents who live there. The neighbourhoods are referred to regularly throughout the Gleadless Valley Masterplan, and the map on the right provides a useful key for defining each local area.

The full 2018 Baseline Report is available in Appendix 1 for information. This Baseline Report was produced in 2018 to analyse the social, economic, and environmental conditions in Gleadless Valley, in order to provide a robust knowledge basis to inform the Gleadless Valley Masterplan 2022.

It should be noted that 4 years have passed since the project commenced, and it is recognised that the original baseline facts and figures have now changed. Future designers and consultants should conduct up to date baseline /contextual research to influence their decision-making process.



A neighbourhood map from the Baseline Report, 2018